





Massima forza, tenuta pistone + SKUDO - Maximum force, piston seal + SKUDO - Maximale Kraft, Kolbendichtung + SKUDO - Force maximale, piston étanche + SKUDO - Máxima fuerza, estanqueidad pistón + SKUDO - Força máxima, estanquidade no pistão + SKUDO

SEALING	PISTON SEAL
DESIGN	PISTON - BODY DESIGN

1	Plug	5	Back-up ring	9	Outer seal
2	Valve	6	Bush	10	Rod wiper
3	Body	7	Guide ring	11	Rod (nitrited superfinished)
4	Piston seal	8	Retaining ring		

RANGE CHART

Model	Rev. Self contained	Body Ø		Stroke Cu		Initial force F0					
		mm	inch	mm	inch	daN	lb	OSAS	USAS	OPAS	SKUDO
SK 4	.2	25	0.98	6 - 50	0.39 - 1.97	425	955	-	-	-	✓
SK 7,5	.3	32	1.26	6 - 50	0.39 - 1.97	740	1664	✓	✓	✓	✓
SK 10	.3	38	1.50	6 - 50	0.24 - 1.97	1060	2383	✓	✓	✓	✓
SK 18	.3	50	1.97	6 - 65	0.24 - 1.97	1885	4238	✓	✓	✓	✓
SK 30	.3	63	2.48	10 - 65	0.39 - 1.97	2945	6620	✓	✓	✓	✓
SK 47	.3	75	2.95	10 - 65	0.39 - 1.97	4675	10510	✓	✓	✓	✓
SK 75	.3	95	3.74	10 - 65	0.39 - 1.97	7540	16950	✓	✓	✓	✓
SK 120	.3	120	4.72	10 - 65	0.39 - 1.97	11780	26481	✓	✓	✓	✓
SK 185	.3	150	5.91	10 - 65	0.39 - 1.97	18410	41386	✓	✓	✓	✓

HOW TO ORDER



Available versions

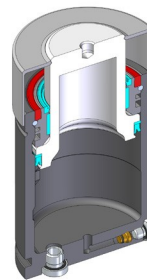

SK 18-50.3
Standard code

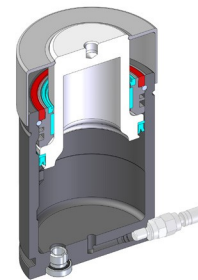

SK 18-50.3-C
Add "-C" to standard code

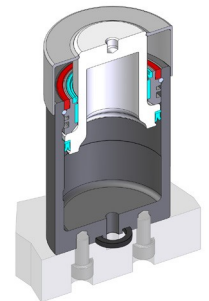

SK 18-50.3-ED
Add "-ED" to standard code

