

ISO	VDI	BMW	FCA
Ford	Mazda	MB	Nissan
PSA	Renault	VW	

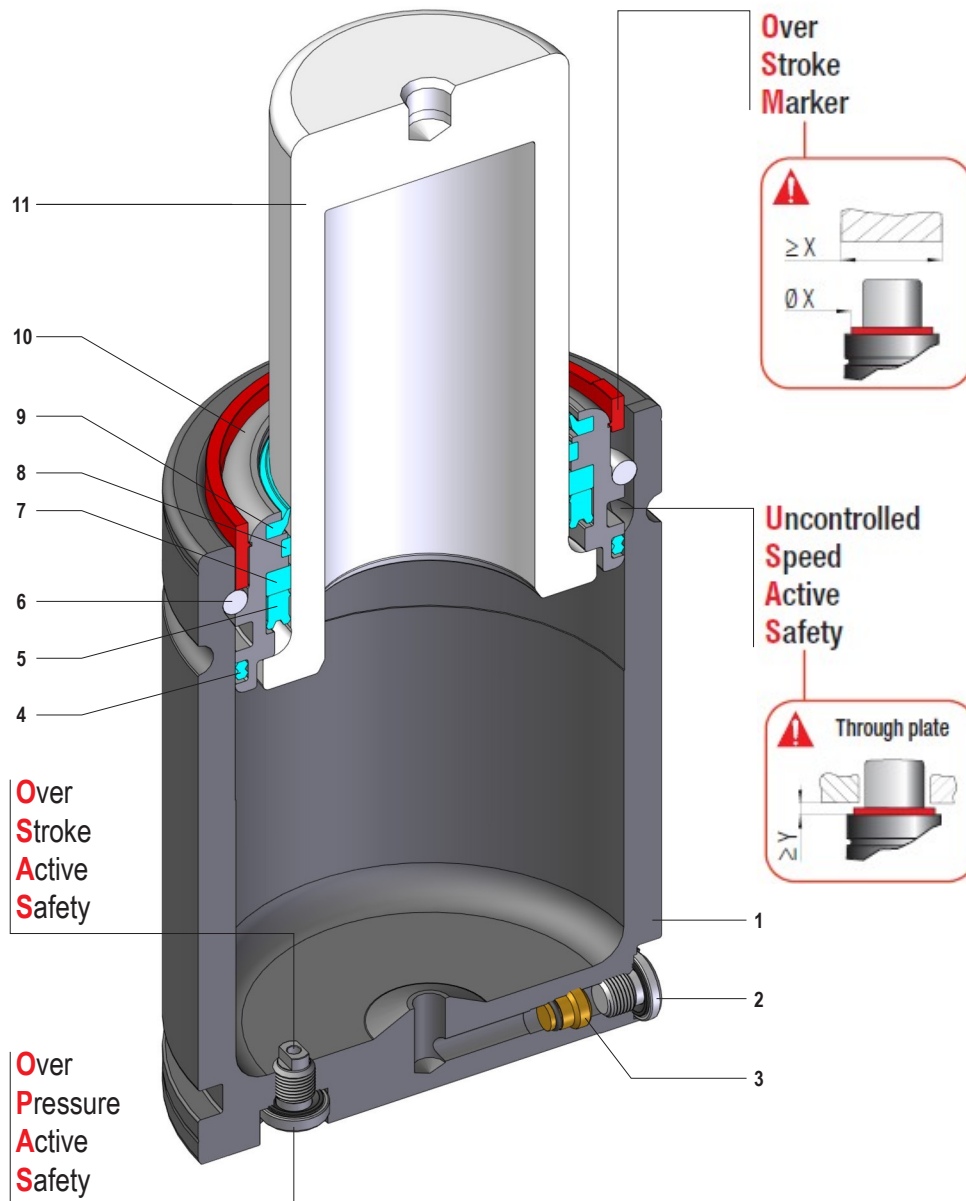





Minima altezza, massima forza - Minimum height, maximum force - Minimale Höhe, maximale Kraft
Hauteur minimale, force maximale - Mínima altura, máxima fuerza - Altura mínima, força máxima

SEALING	ROD SEAL
DESIGN	BUSH - BODY DESIGN

1	Body	5	Rod seal	9	Rod wiper
2	Plug	6	Retaining ring	10	Bush
3	Valve	7	Back-up ring	11	Rod (nitrited superfinished)
4	Dual ring seal	8	Guide ring		

RANGE CHART

Model	Rev.	Body Ø		Stroke Cu		Initial force F0						
		Self contained	mm	inch	mm	inch	daN	lb	OSAS	USAS	OPAS	SKUDO
KD 1,7	.4	19	0.75	7 - 125	0.28 - 4.92	170	382	✓	✓	✓	-	✓
KD 3,2	.4	25	0.98	7 - 125	0.28 - 4.92	320	719	✓	✓	✓	-	✓
KD 3,5	.3	32	1.26	10 - 125	0.39 - 4.92	360	809	✓	✓	✓	-	✓
KD 5	.3	38	1.50	10 - 125	0.39 - 4.92	470	1057	✓	✓	✓	-	✓
KD 7,5	.3	45	1.77	10 - 125	0.39 - 4.92	740	1664	✓	✓	✓	-	✓
KD 10	.3	50	1.97	10 - 125	0.39 - 4.92	920	2068	✓	✓	✓	-	✓
KD 12	.3	50	1.97	10 - 125	0.39 - 4.92	1060	2383	✓	✓	✓	-	✓
KD 15	.4	63	2.48	10 - 125	0.39 - 4.92	1530	3440	✓	✓	✓	-	✓
KD 24	.3	75	2.95	10 - 125	0.39 - 4.92	2385	5362	✓	✓	✓	-	✓
KD 42	.3	95	3.74	16 - 125	0.63 - 4.92	4240	9532	✓	✓	✓	-	✓
KD 66	.3	120	4.72	16 - 125	0.63 - 4.92	6630	14905	✓	✓	✓	-	✓
KD 95	.3	150	5.91	19 - 125	0.75 - 4.92	9540	21447	✓	✓	✓	-	✓
KD 120	.3	150	5.91	19 - 125	0.75 - 4.92	11780	26470	✓	✓	✓	-	✓
KD 200	.3	195	7.68	19 - 125	0.75 - 4.92	19910	44738	✓	✓	✓	-	✓

✓ Built-in as standard

✓ Optional upon request

HOW TO ORDER

Series _____ Revision code _____

Model **KD 24-50.3-E-W**

Stroke _____ Version _____

Available versions

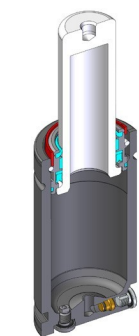

KD 24-50.3

Standard code



Self contained

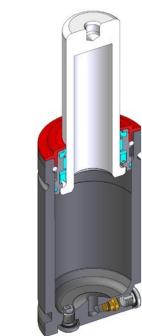

KD 24-50.3-W

Add "-W" to standard code



Self contained

+ Secondary wiper

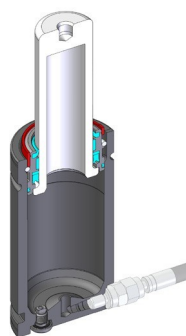

KD 24-50.3-C

Add "-C" to standard code



Linkable

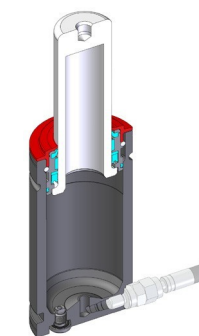

KD 24-50.3-C-W

Add "-C-W" to standard code



Linkable

+ Secondary wiper

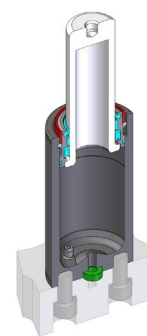

KD 24-50.3-E

Add "-E" to standard code



Easy Manifold

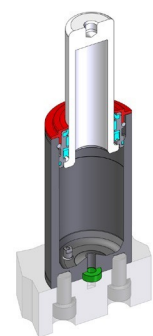

KD 24-50.3-E-W

Add "-E-W" to standard code



Easy Manifold

+ Secondary wiper