

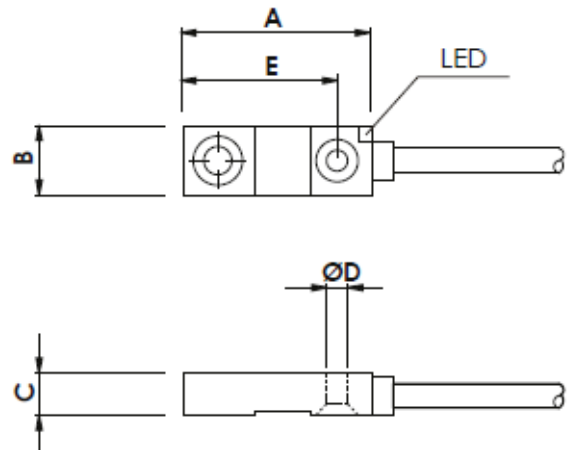

Teilerkennungssensor / Part presence sensor NBN

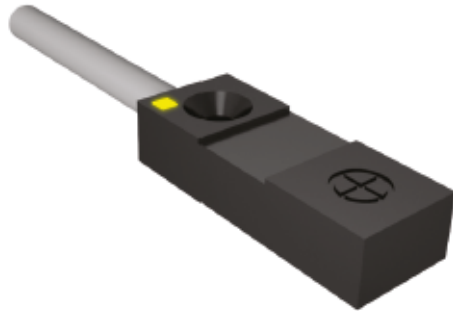

Schaltplan
/ Electrical connections

Material: PPS
Schutzklasse: IP67
Schrauben: enthalten

Material: PPS
Protection degrees: IP67
Bolts: Included

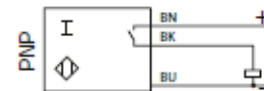

CODE	A	B	C	ØD	E	Kabellänge	Kabelquerschnitt / Core cross-section	Schaltplan / Electric scheme	Schaltabstand / Sensing distance
NBN4-F29-E2	27	10	6	3	22	2 m	1 x 0,14 mm ²	NO PNP	4 mm
NBN4-F29-E2-3M	27	10	6	3	22	3 m	1 x 0,14 mm ²	NO PNP	4 mm
NBN4-F29-E3-5M	27	10	6	3	22	5 m	1 x 0,14 mm ²	NC PNP	4 mm



Teilerkennungssensor / Part presence sensor

NBB

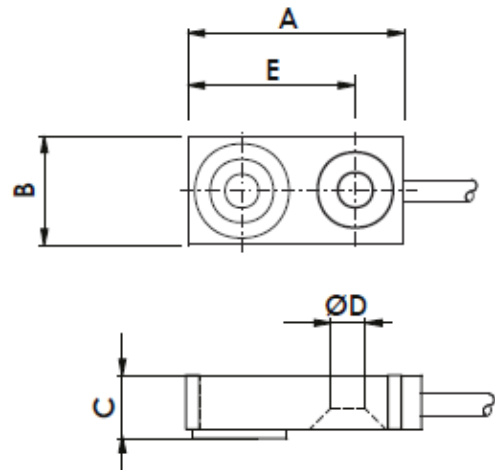
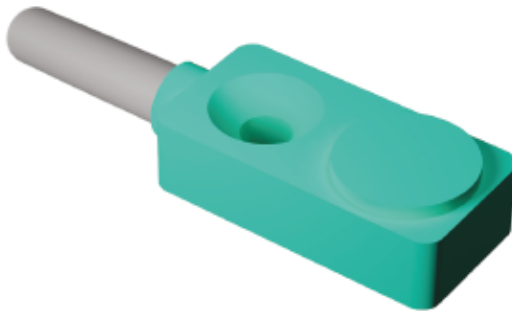

Schaltplan
/ Electrical connections

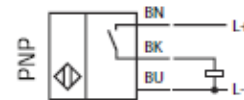

Material: PA
Schutzklasse: IP67
Schrauben: enthalten

Material: PA
Protection degrees: IP67
Bolts: Included

CODE	A	B	C	Ø D	E	Kabellänge / Cable Length	Kabelquerschnitt / Core cross section	Schaltplan / Electric scheme	Schaltabstand / Sensing distance
NBB1,5-F79-E2	16	8	4,7	2,6	12	0,5 m	3x0,08 mm ²	NO PNP	1,5 mm



Näherungsschalter M8 / Proximity sensor M8 IE5351

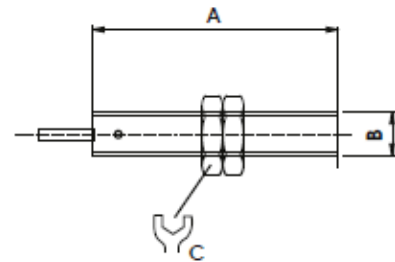

Kabel mit M12 Stecker
Material: Messing LCP
Montage: eingeklemmt
Schrauben: enthalten

Cable with male connector: M 8
Material: Brass LCP
Assembly: Embedded
Bolts: Included

Schaltplan / Electrical connections

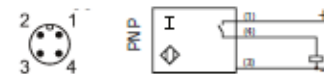

CODE	A	B	C	Kabellänge	Kabelquerschnitt / Core cross-section	Gewicht / Weight (Kg)	Schaltplan / Electric scheme	Schaltabstand / Sensing distance
IE5351	35	M 8X1	13	0,3 m	3 x 0,14 mm ²	0,34	NO PNP	3 mm

Näherungsschalter M12 / Proximity sensor M12 IME12

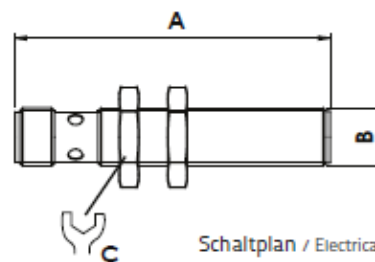

Kabel mit M12 Stecker
Material: Messing LCP
Montage: eingeklemmt
Schrauben: enthalten

Embedded male connector: M 12
Material: Nickel-plated brass LCP
Bolts: Included

Schaltplan / Electrical connections

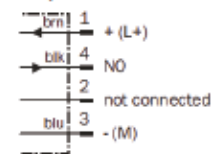

CODE	A	B	C	E	Kabellänge	Gewicht / Weight (Kg)	Schaltplan / Electric scheme	Schaltabstand / Sensing distance
IME12-04BPSZCOS	65	M 12x1	17	--	--	0,015	NO PNP	4 mm



optometrischer Sensor / Optometric sensor

OGL

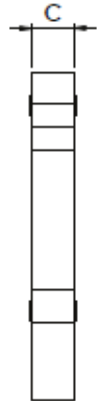
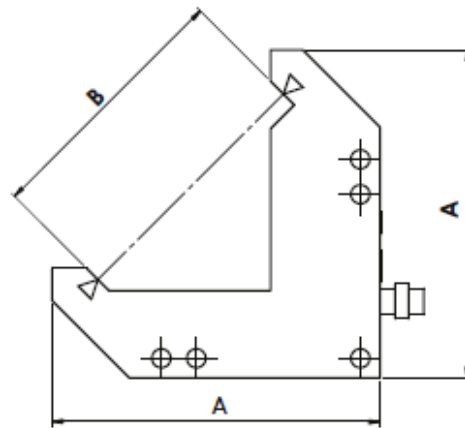
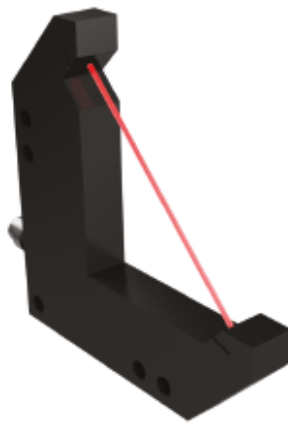

Schaltplan / Electrical connections

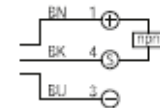
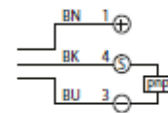

Material: Aluminium
Schutzklasse: IP67
Behandlung: schwarz eloxiert

Material: Aluminium
Protection degree: IP67
Treatment: Black anodizing

CODE	A	B	C	D	E	F	Gewicht / Weight (Kg)	Schaltplan / Electric scheme
OGL-P	75	60	10	--	--	--	--	PNP
OGL-N	75	60	10	--	--	--	--	NPN



gerader, loser M12 Stecker / Steering straight male connector M12
RSC 4/7



4 POLE
/ 4 POLES



Schaltplan
/ Electrical connections

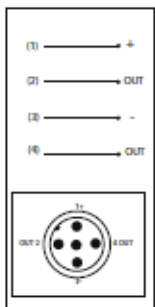

90°, loser M12 Stecker / Steering 90° male connector M12
RSCW 4/7



4 POLE
/ 4 POLES

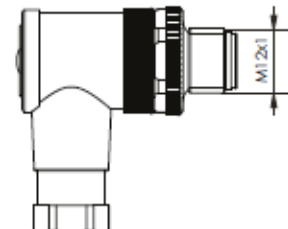



gerade M12 Buchse mit Kabel / Cabled female straight connector M12

9457730300
9457730500

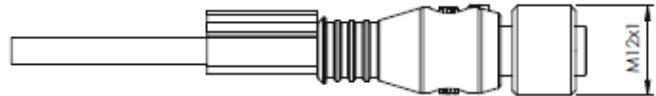

Schutzklasse: IP67
Polanzahl: 4

Protection degree: IP67
Poles N°: 4

Bestellbeispiel
/ Ordering example

9457730

300

Kabellänge 3m
/ cable's length 3m

9457730

500

Kabellänge 5m
/ cable's length 5m

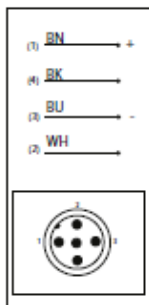

Schaltplan
/ Electrical connections

90° M12 Buchse mit Kabel / Cabled female 90° connector M12

9457740300
9457740500

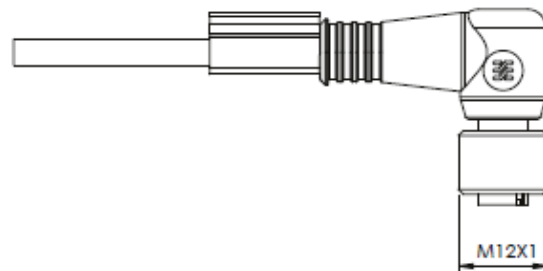

Schutzklasse: IP67
Polanzahl: 4

Protection degree: IP67
Poles N°: 4

Bestellbeispiel
/ Ordering example

94557740

300

Kabellänge 3m
/ cable's length 3m

94557740

500

Kabellänge 5m
/ cable's length 5m



Y Anschluss M12 für Serie / Y Connector M12 for series ASBSA2M12-3



4 POLE
/ 4 POLES

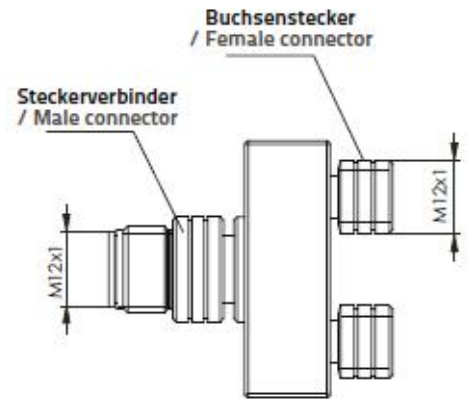
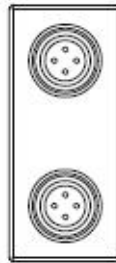

Schutzklasse: IP67
/ Protection degree: IP67



Kupplungseinsatz "A"
/ female connector "A"

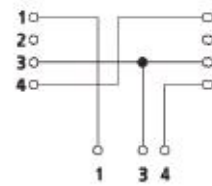

Kupplungseinsatz "B"
/ female connector "B"

Steckereinsatz
/ male connector

Schaltplan
/ Electrical connections



Sensor/Aktor-Passiv-Verteiler / Sensor-actuator-interface

9456750000

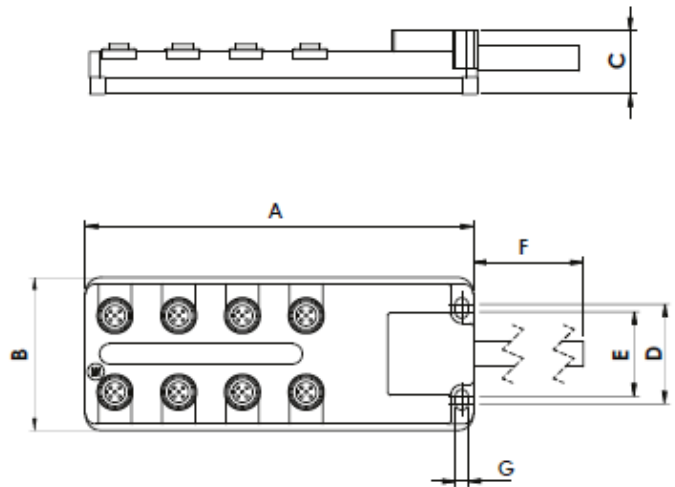

Anzahl Kontaktbuchsen: 8
 Kontaktbuchsendurchmesser: M12
 Polanzahl: 4

Schutzklasse: IP68

Contacts N°: 8
 Plug-in diameter: M12
 Poles N°: 4

Protection degree: IP68

Schaltplan / Electrical connections

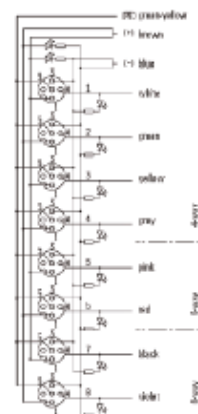

CODE	A	B	C	D	E	F (m)	G	Gewicht / Weight (Kg)
9456750000	152	60	25	39	33	5	5	0,693



Elektrische Stecker auf Anfrage / Electrical plugs upon request

CKA03VS-CDM08



CHP16-CNEF16T



CAV1029-CDDM42



CHP24L-CNEM24T

