

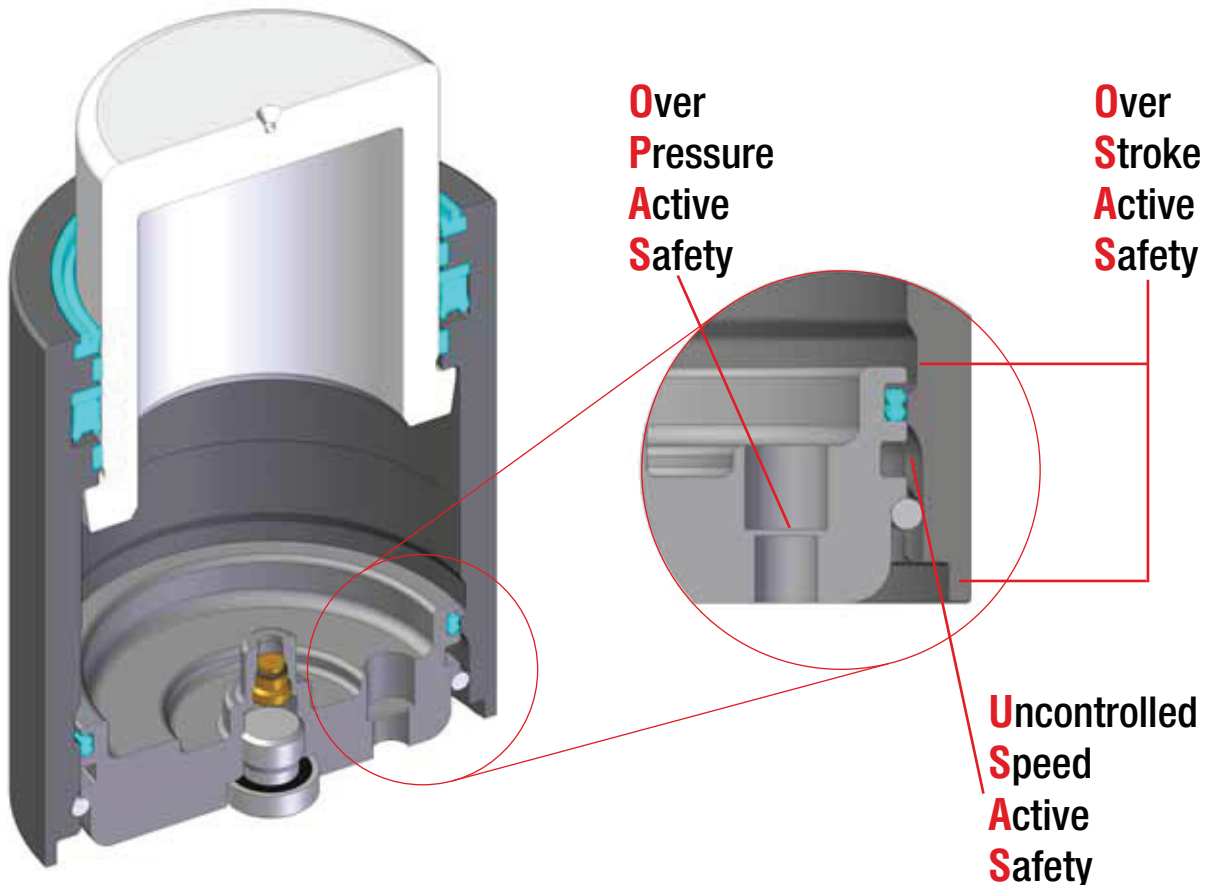

PED
97/23/EC



Range chart

Model	Body Ø		Stroke Cu		Initial force					
	mm	inch	mm	inch	daN	lb	OPAS	OSAS	SKUDO	USAS
KM 3	25	0,98	10 - 80	0,39 - 3,15	310	697	-	✓	-	✓
KM 5	32	1,26	10 - 80	0,39 - 3,15	510	1147	-	✓	-	✓
KM 10	38	1,50	10 - 80	0,39 - 3,15	980	2203	✓	✓	-	✓
KM 10 C	38	1,50	10 - 80	0,39 - 3,15	980	2203	✓	✓	-	✓
KM 18	50	1,97	15 - 80	0,59 - 3,15	1925	4327	✓	✓	-	✓
KM 18 C	50	1,97	15 - 80	0,59 - 3,15	1925	4327	✓	✓	-	✓
KM 30	63	2,48	15 - 80	0,59 - 3,15	3180	7149	✓	✓	-	✓
KM 30 C	63	2,48	15 - 80	0,59 - 3,15	3180	7149	✓	✓	-	✓
KM 47	75	2,95	15 - 80	0,59 - 3,15	4925	11071	✓	✓	-	✓
KM 47 C	75	2,95	15 - 80	0,59 - 3,15	4925	11071	✓	✓	-	✓
KM 75	95	3,74	15 - 80	0,59 - 3,15	7700	17310	✓	✓	-	✓
KM 75 C	95	3,74	15 - 80	0,59 - 3,15	7700	17310	✓	✓	-	✓
KM 120	120	4,72	15 - 80	0,59 - 3,15	12720	28595	✓	✓	-	✓
KM 120 C	120	4,72	15 - 80	0,59 - 3,15	12720	28595	✓	✓	-	✓



How to Order

KM18-50 - C - EN

Codice cilindro autonomo
Self-contained cylinder code
Kode des eingeständiges Zylinder
Code du cylindre autonome
Codigo del cilindro autónomo
Codigo do cilindro autónomo

Collegabile con tubi, fornito scarico e senza valvola unidirezionale, L+20 mm
Linkable with hoses, supplied without pressure and oneway valve, L+20 mm
Anschlussfähig mit Leitungen, geliefert ohne Druck und RückschlagVentil, L+20 mm
Connectable avec tubes, fourni sans pression ni valve unidirectionelle, L+20 mm
Connectable con tubos, suministrado sin presión y sin válvula unidireccional, L+20 mm
Acompláveis com tubos, fornecidos sem pressão e sem válvula unidireccional, L+20 mm

Collegabile EASY MANIFOLD, fornito scarico senza valvola + NIPPLE di collegamento
Linkable EASY MANIFOLD, supplied without pressure and valve + NIPPLE connecting
Anschlussfähig EASY MANIFOLD, geliefert ohne Druck und ohne Ventil + NIPPEL
Verbindungs
Connectable EASY MANIFOLD, fourni sans pression ni valve + NIPPLE de connexion
Connectable EASY MANIFOLD, suministrado sin presión y sin válvula + NIPLE de conexión
Acompláveis EASY MANIFOLD, fornecidos sem pressão e sem válvula + LIGACÃO
INTERIOR de conexão

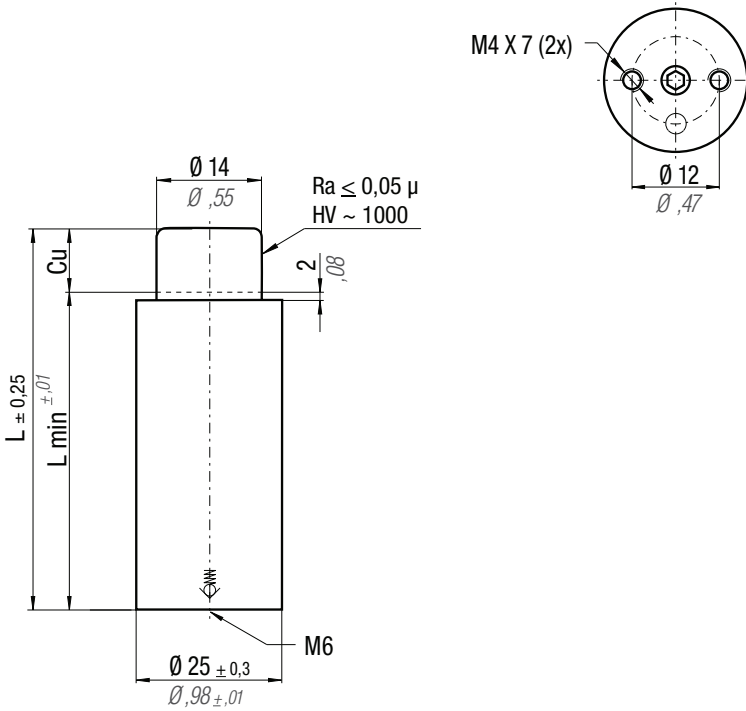

Info

* 100% Cu - Polytropic end forces

CODE	Cu		L		L min		F0		F1 *		V0		Maintenance kit		
	mm	inch	mm	inch	mm	inch	daN	lb	daN	lb	cm ³	in ³	~Kg	~lb	Cat.
KM 3 - 10	10	0,39	75	2,95	65	2,56	310	697	473	1063	-	-	0,18	0,40	-
KM 3 - 15	15	0,59	85	3,35	70	2,76	200 bar 2900 psi		521	1171	-	-	0,19	0,42	-
KM 3 - 25	25	0,98	105	4,13	80	3,15			589	1324	-	-	-	-	0,22
KM 3 - 38	38	1,50	130	5,12	92	3,62	± 5% +20 °C +68 °F		653	1468	-	-	0,25	0,55	-
KM 3 - 50	50	1,97	155	6,10	105	4,13			677	1522	-	-	-	-	0,28
KM 3 - 63	63	2,48	185	7,28	122	4,80	672	1511	-	-	-	-	0,33	0,73	-
KM 3 - 80	80	3,15	220	8,66	140	5,51	692	1556	-	-	-	-	0,38	0,84	-

KM

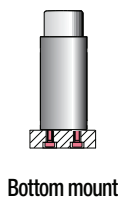
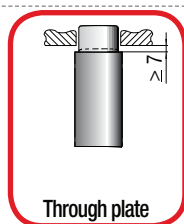
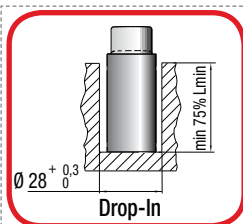

HOW TO ORDER

(10 pcs) KM3-50

Info

* 100% Cu - Polytropic end forces

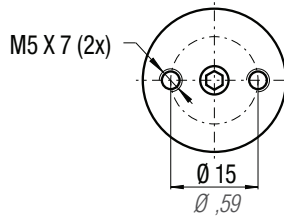
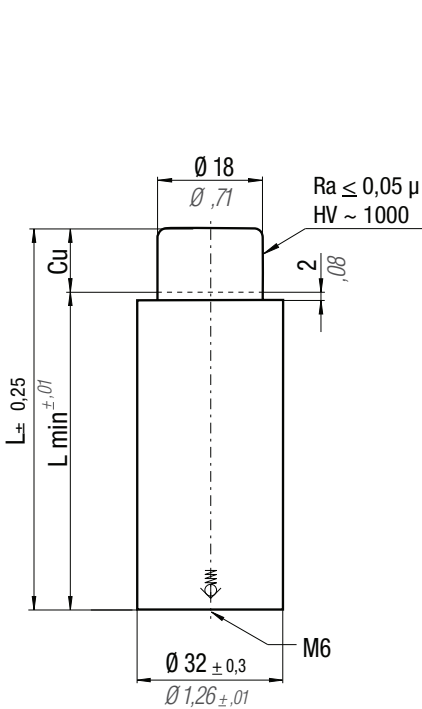

CODE	N ₂	°F 32 - 176	°C 0 - 80	ΔP ± 0,33 %/°C	P max 200 bar 2900 psi	P min 20 bar 290 psi	S 2,54 cm ² 0,394 in ²	SPM ~ 40 - 80 (at 20°C)	Max Speed 1,6 m/s	Maintenance kit Disposable	Cu		L		L min		F ₀ Initial force		F ₁ End force *		V ₀		Cat.			
											mm	inch	mm	inch	mm	inch	daN	lb	daN	lb	cm ³	in ³	~Kg	~lb		
KM 5 - 10												10	0,39	75	2,95	65	2,56	510	1147	779	1751	-	-	0,30	0,66	-
KM 5 - 15												15	0,59	85	3,35	70	2,76			853	1918	-	-	0,33	0,73	-
KM 5 - 25												25	0,98	105	4,13	80	3,15	200 bar		951	2138	-	-	0,36	0,79	-
KM 5 - 38												38	1,50	130	5,12	92	3,62	2900 psi		1044	2347	-	-	0,42	0,93	-
KM 5 - 50												50	1,97	155	6,10	105	4,13			1075	2417	-	-	0,46	1,01	-
KM 5 - 63												63	2,48	190	7,48	127	5,00	± 5%		1017	2286	-	-	0,54	1,19	-
KM 5 - 80												80	3,15	225	8,86	145	5,71	+20 °C +68 °F		1051	2363	-	-	0,63	1,39	-

Drop-in

Through plate

Bottom mount

06476/C - 06755/C

HOW TO ORDER

(10 pcs) KM5-50

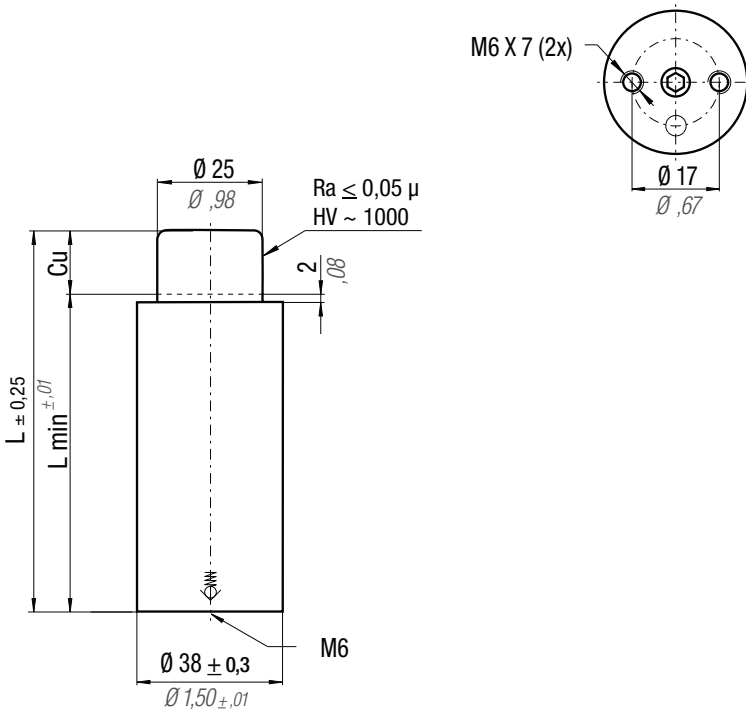

Info

* 100% Cu - Polytropic end forces

CODE	N ₂	°F 32 - 176	°C 0 - 80	ΔP ± 0,33 %/°C	P max 200 bar 2900 psi	P min 20 bar 290 psi	S 4,91 cm ² 0,761 in ²	SPM ~ 40 - 80 (at 20°C)	Max Speed 1,6 m/s	Maintenance kit 39BMKM10	
										~Kg	~lb
KM 10 - 10										0,40	0,88
KM 10 - 15										0,43	0,95
KM 10 - 25										0,49	1,08
KM 10 - 38										0,58	1,28
KM 10 - 50										0,66	1,46
KM 10 - 63										0,80	1,76
KM 10 - 80										0,87	1,92

FKM 10

code: 39FML01000A

Kit speciale per trasformare cilindri autonomi
Special kit to convert self-contained cylinders
Spezial-Set zum Umbau eigenständiger Zylinder
Kit spécial pour transformer les cylindres autonomes
Kit especial para transformar cilindros autónomos
Kit especial para transformar cilindros autónomos

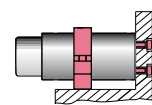
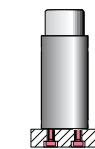
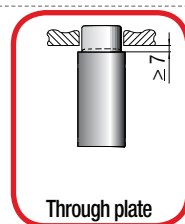
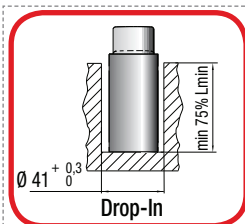
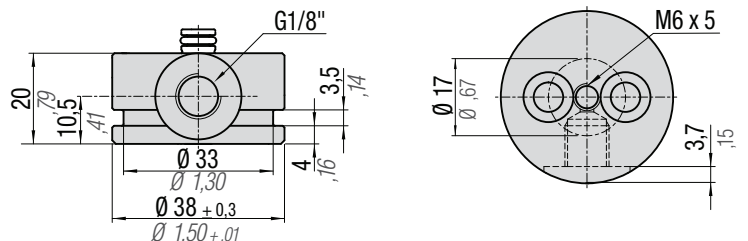

HOW TO ORDER

(10 pcs) KM10-50

KM 10 C

linkable G1/8"

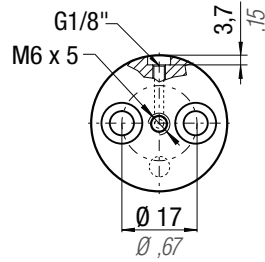
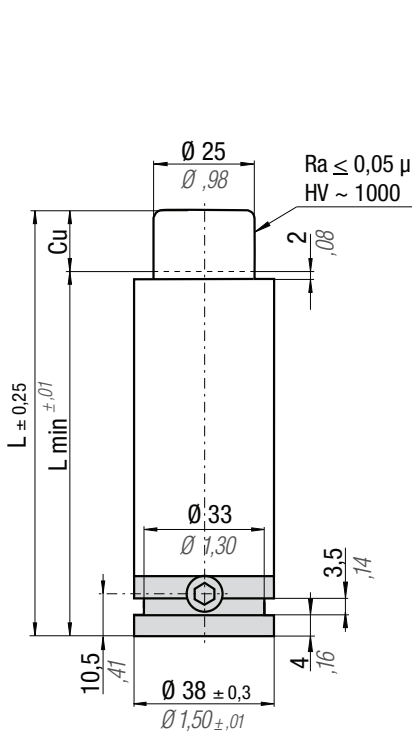

Info

* 100% Cu - Polytropic end forces

CODE	N ₂	°F 32 176	°C 0 80	ΔP ± 0,33 %/°C	P max 200 bar 2900 psi	P min 20 bar 290 psi	S 4,91 cm ² 0,761 in ²	SPM ~ 40 - 80 (at 20°C)	Max Speed 1,6 m/s	Maintenance kit 39BMKM10	Cu		L		L min		F ₀		F ₁		V ₀		Cat.			
											mm	inch	mm	inch	mm	inch	daN	lb	daN	lb	cm ³	in ³	~Kg	~lb		
KM10-10-C												10	0,39	95	3,74	85	3,35	980	2203	1592	3579	18,0	1,10	0,56	1,23	-
KM10-15-C												15	0,59	105	4,13	90	3,54			1780	4002	23,0	1,40	0,59	1,30	-
KM10-25-C												25	0,98	125	4,92	100	3,94	200 bar		2047	4602	33,0	2,01	0,65	1,43	-
KM10-38-C												38	1,50	155	6,10	117	4,61	2900 psi		2141	4813	48,0	2,93	0,74	1,63	-
KM10-50-C												50	1,97	180	7,09	130	5,12			2259	5078	60,0	3,66	0,82	1,81	-
KM10-63-C												63	2,48	225	8,86	162	6,38	± 5%		2019	4539	86,0	5,25	0,96	2,12	-
KM10-80-C												80	3,15	260	10,24	180	7,09	+20 °C +68 °F		2134	4797	103,0	6,28	1,03	2,27	-

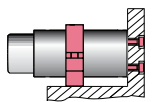
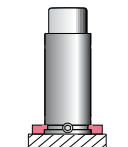
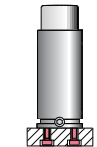
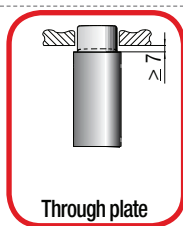
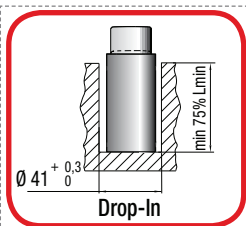

Bottom mount 06180 - 06150
06029 - 06159 06297/C - 06769/C

HOW TO ORDER

(10 pcs) KM10-50-C

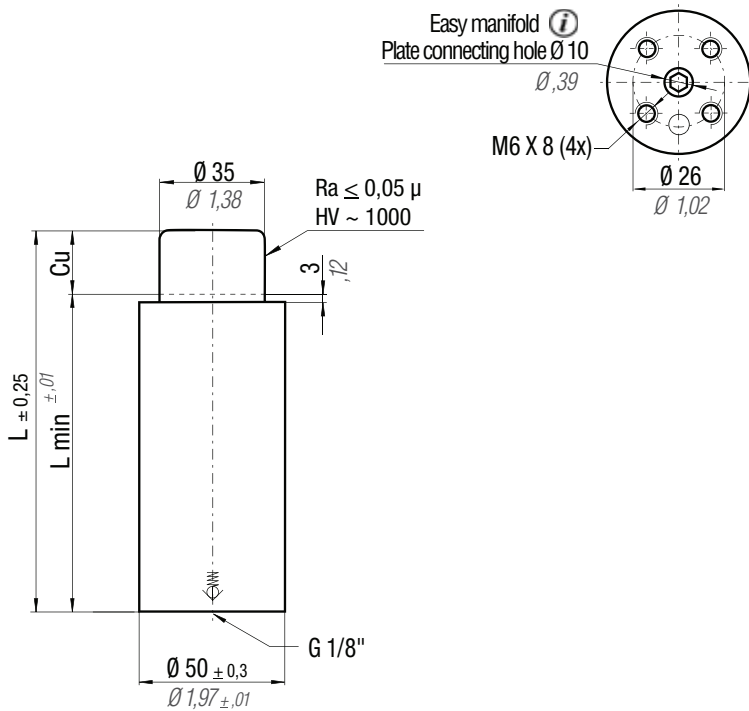

Info

* 100% Cu - Polytropic end forces

page 164

For Easy manifold replacement units quote product code marked on your cylinders.

N ₂	°F 32 - 176	°C 0 - 80	ΔP ± 0,33 %/°C	P max 200 bar 2900 psi	P min 20 bar 290 psi	S 9,62 cm ² 1,491 in ²	SPM ~ 40 - 80 (at 20°C)	Max Speed 1,6 m/s	Maintenance kit 39BMKM18						
CODE			Cu	L	L min	F0 Initial force	F1 End force *	V0		CE					
	mm	inch	mm	inch	mm	inch	daN	lb	cm ³	in ³	~Kg	~lb	Cat.		
KM 18 - 15	15	0,59	95	3,74	80	3,15	1925	4327	3161	7106	-	-	0,84	1,85	-
KM 18 - 25	25	0,98	115	4,53	90	3,54			3661	8230	-	-	0,92	2,03	-
KM 18 - 38	38	1,50	150	5,91	112	4,41			3762	8457	-	-	1,11	2,45	-
KM 18 - 50	50	1,97	175	6,89	125	4,92			4034	9069	-	-	1,22	2,69	-
KM 18 - 63	63	2,48	205	8,07	142	5,59			4367	9817	-	-	1,38	3,04	-
KM 18 - 80	80	3,15	245	9,65	165	6,50	± 5%	+20 °C +68 °F	4271	9602	-	-	1,57	3,46	-

KM

FKM 18

code: 39FML01800A

Kit speciale per trasformare cilindri autonomi
Special kit to convert self-contained cylinders
Spezial-Set zum Umbau eigenständiger Zylinder
Kit spécial pour transformer les cylindres autonomes
Kit especial para transformar cilindros autónomos
Kit especial para transformar cilindros autónomos

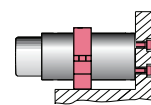
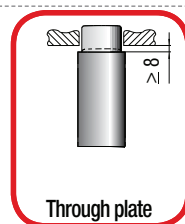
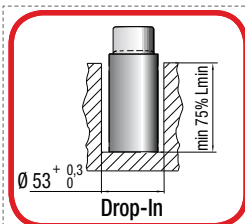
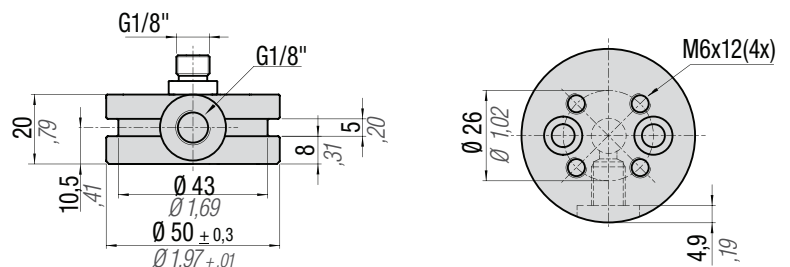

Through plate Bottom mount 04756/C - 06756/C

HOW TO ORDER

(10 pcs) KM18-50
(10 pcs) KM18-50-EN

KM 18 C

linkable G1/8"

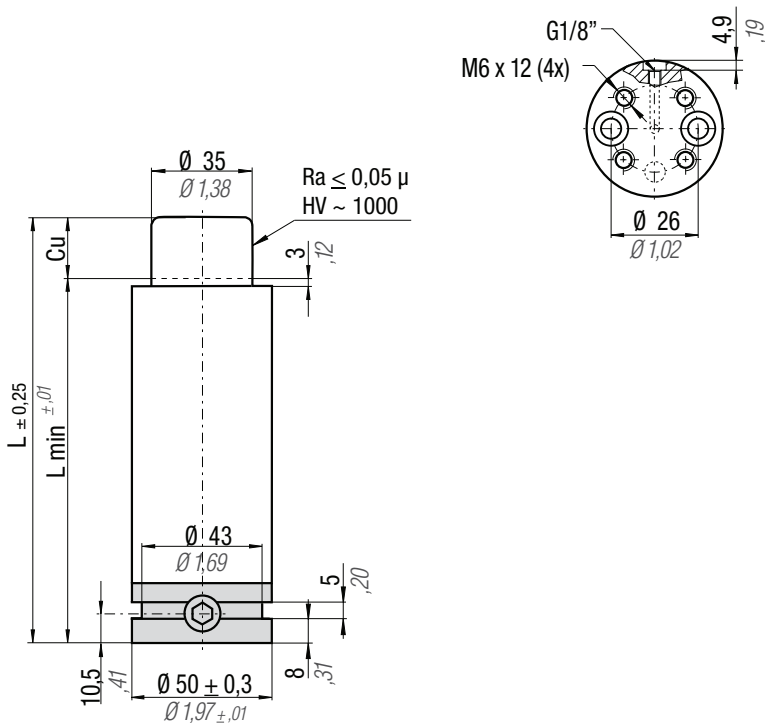

Info

* 100% Cu - Polytropic end forces

CODE	N ₂	°F 32 - 176	°C 0 - 80	ΔP ± 0,33 %/°C	P max 200 bar 2900 psi	P min 20 bar 290 psi	S 9,62 cm ² 1,491 in ²	SPM ~ 40 - 80 (at 20°C)	Max Speed 1,6 m/s	Maintenance kit 39BMKM18	Cu		L		L min		F ₀		F ₁		V ₀		~Kg	~lb	Cat.
											mm	inch	mm	inch	mm	inch	daN	lb	daN	lb	cm ³	in ³			
KM18-15-C											15	0,59	115	4,53	100	3,94	1925	4327	3161	7106	49,0	2,99	1,14	2,51	-
KM18-25-C											25	0,98	135	5,31	110	4,33	200 bar	2900 psi	3661	8230	67,0	4,09	1,22	2,69	-
KM18-38-C											38	1,50	170	6,69	132	5,20			3762	8457	102,0	6,22	1,41	3,11	-
KM18-50-C											50	1,97	195	7,68	145	5,71			4034	9069	125,0	7,63	1,52	3,35	-
KM18-63-C											63	2,48	225	8,86	162	6,38	± 5%		4367	9817	154,0	9,40	1,68	3,70	-
KM18-80-C											80	3,15	265	10,43	185	7,28	+20 °C +68 °F		4271	9602	193,0	11,78	1,87	4,12	-

Drop-in

Through plate

Bottom mount

04754 - 06152
06189 - 06161
04756/C - 06756/C

HOW TO ORDER

(10 pcs) KM18-50-C

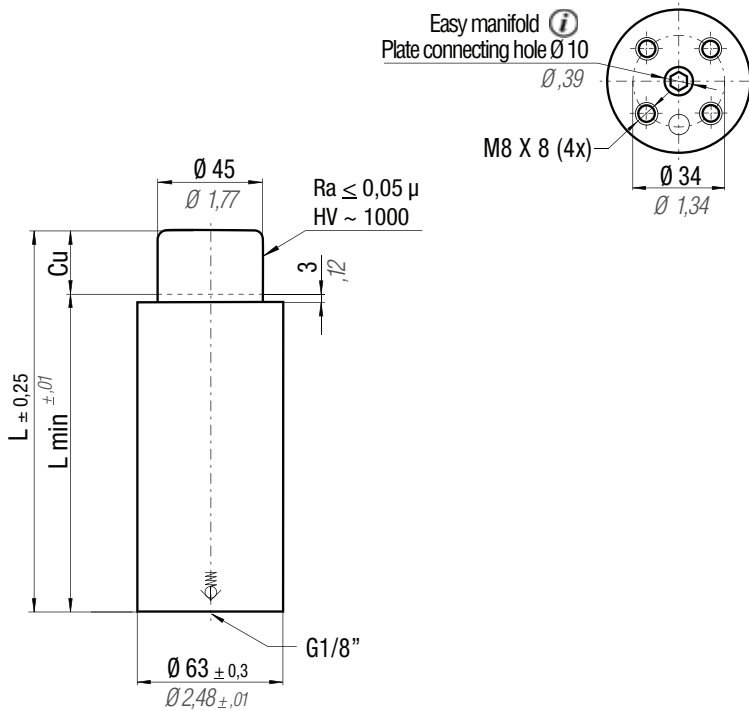

Info

* 100% Cu - Polytropic end forces

page 164

For Easy manifold replacement units quote product code marked on your cylinders.

N ₂	°F 32 - 176	°C 0 - 80	ΔP ± 0,33 %/°C	P max 200 bar 2900 psi	P min 20 bar 290 psi	S 15,90 cm ² 2,464 in ²	SPM ~ 40 - 80 (at 20°C)	Max Speed 1,6 m/s	Maintenance kit 39BMKM30						
CODE			Cu	L	L min	F0 Initial force	F1 End force *	V0		CE					
	mm	inch	mm	inch	mm	inch	daN	lb	cm ³	in ³	~Kg	~lb	Cat.		
KM 30 - 15	15	0,59	100	3,94	85	3,35	3180	7149	5114	11497	-	-	1,33	2,93	-
KM 30 - 25	25	0,98	120	4,72	95	3,74			5895	13252	-	-	1,47	3,24	-
KM 30 - 38	38	1,50	150	5,91	112	4,41			6354	14284	-	-	1,69	3,73	-
KM 30 - 50	50	1,97	180	7,09	130	5,12			6500	14613	-	-	1,92	4,23	-
KM 30 - 63	63	2,48	210	8,27	147	5,79			6716	15098	-	-	2,14	4,72	-
KM 30 - 80	80	3,15	250	9,84	170	6,69	± 5% +20 °C +68 °F		6883	15474	-	-	2,44	5,38	-

KM

FKM 30

code: 39FML03000A

Kit speciale per trasformare cilindri autonomi
Special kit to convert self-contained cylinders
Spezial-Set zum Umbau eigenständiger Zylinder
Kit spécial pour transformer les cylindres autonomes
Kit especial para transformar cilindros autónomos
Kit especial para transformar cilindros autónomos

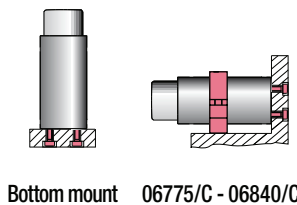
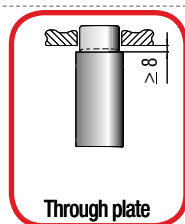
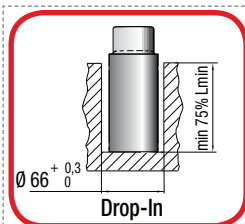
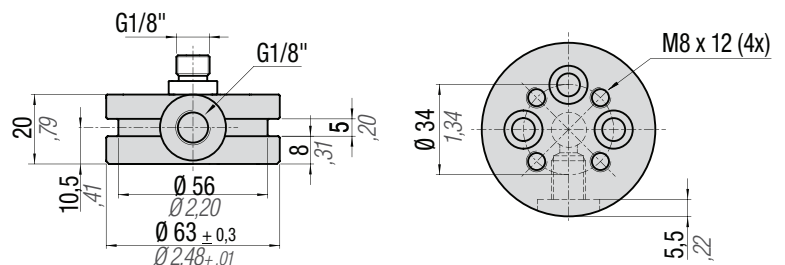

HOW TO ORDER

(10 pcs) KM30-50
(10 pcs) KM30-50-EN

KM 30 C

linkable G1/8"



Info

* 100% Cu - Polytropic end forces

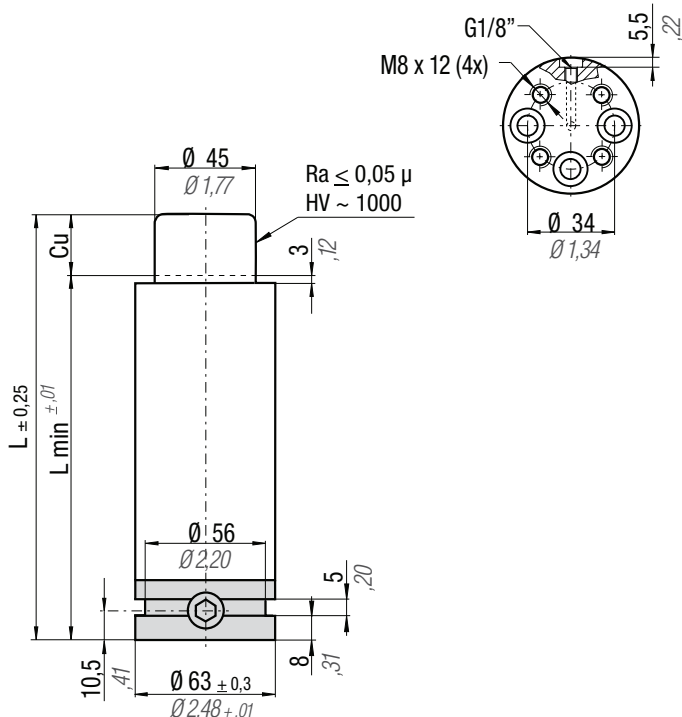

CODE	N ₂	°F 32 - 176	°C 0 - 80	ΔP $\pm 0,33 \% / ^\circ C$	P max 200 bar 2900 psi	P min 20 bar 290 psi	S 15,90 cm ² 2,464 in ²	SPM ~ 40 - 80 (at 20°C)	Max Speed 1,6 m/s	Maintenance kit 39BMKM30	Cu		L		L min		F ₀ Initial force		F ₁ End force *		V ₀		Cat.			
											mm	inch	mm	inch	mm	inch	daN	lb	daN	lb	cm ³	in ³	~Kg	~lb		
KM30-15-C												15	0,59	120	4,72	105	4,13	3180	7149	5114	11497	99	6,04	1,71	3,77	-
KM30-25-C												25	0,98	140	5,51	115	4,53	200 bar 2900 psi $\pm 5\%$ +20 °C +68 °F	5895	13252	128	7,81	1,85	4,08	-	
KM30-30-C												38	1,50	170	6,69	132	5,20		6354	14284	174	10,62	2,07	4,56	-	
KM30-50-C												50	1,97	200	7,87	150	5,91		6500	14613	221	13,49	2,30	5,07	-	
KM30-63-C												63	2,48	230	9,06	167	6,57		6716	15098	267	16,29	2,52	5,56	-	
KM30-80-C												80	3,15	270	10,63	190	7,48		6883	15474	328	20,02	2,82	6,22	-	

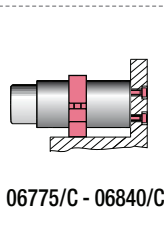
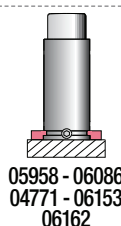
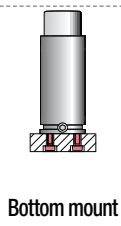
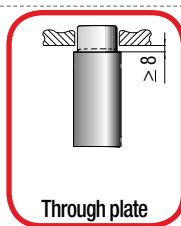
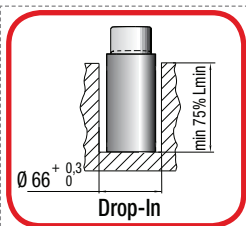

HOW TO ORDER

(10 pcs) KM30-50-C

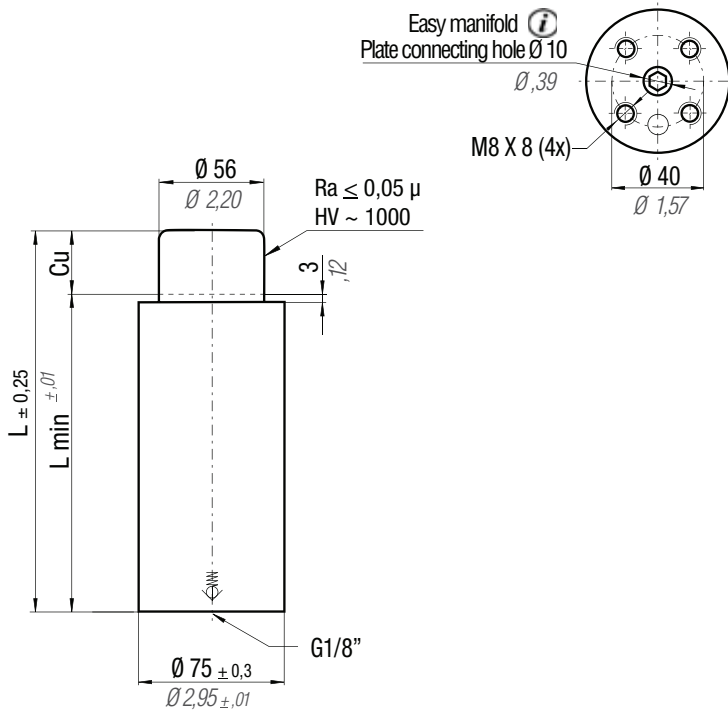

Info

* 100% Cu - Polytropic end forces

page 164

For Easy manifold replacement units quote product code marked on your cylinders.

N ₂	°F 32 - 176	°C 0 - 80	ΔP ± 0,33 %/°C	P max 200 bar 2900 psi	P min 20 bar 290 psi	S 24,63 cm ² 3,817 in ²	SPM ~ 30 - 70 (at 20°C)	Max Speed 1,6 m/s	Maintenance kit 39BMKM47	
CODE	Cu	L	L min	F0 Initial force		F1 End force *		V0		CE
	mm inch	mm inch	mm inch	daN lb	daN lb	cm ³ in ³	~Kg ~lb	Cat.		
KM 47 - 15	15 0,59	100 3,94	85 3,35	4925 11071	8203 18441	- -	1,88 4,14	-		
KM 47 - 25	25 0,98	120 4,72	95 3,74	200 bar 2900 psi	9524 21411	- -	2,08 4,59	-		
KM 47 - 38	38 1,50	150 5,91	112 4,41		10275 23099	- -	2,36 5,20	-		
KM 47 - 50	50 1,97	180 7,09	130 5,12	± 5% +20 °C +68 °F	10499 23603	- -	2,65 5,84	-		
KM 47 - 63	63 2,48	210 8,27	147 5,79		10850 24392	- -	2,92 6,44	-		
KM 47 - 80	80 3,15	250 9,84	170 6,69		11118 24994	- -	3,24 7,14	-		

FKM 47

code: 39FML04700A

Kit speciale per trasformare cilindri autonomi
Special kit to convert self-contained cylinders
Spezial-Set zum Umbau eigenständiger Zylinder
Kit spécial pour transformer les cylindres autonomes
Kit especial para transformar cilindros autónomos
Kit especial para transformar cilindros autónomos

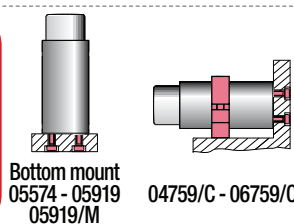
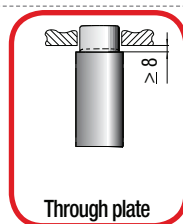
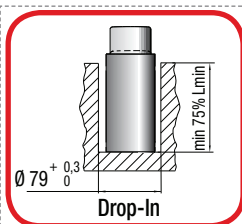
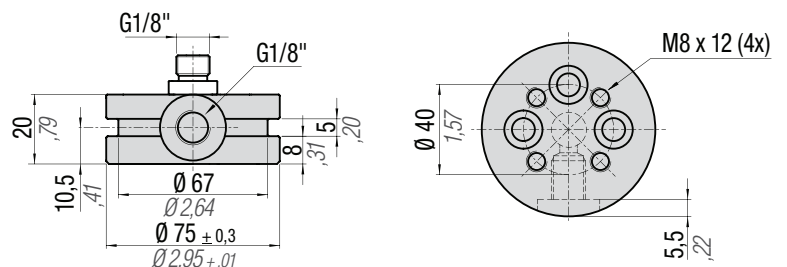

HOW TO ORDER

(10 pcs) KM47-50
(10 pcs) KM47-50-EN

KM 47 C

linkable G1/8"

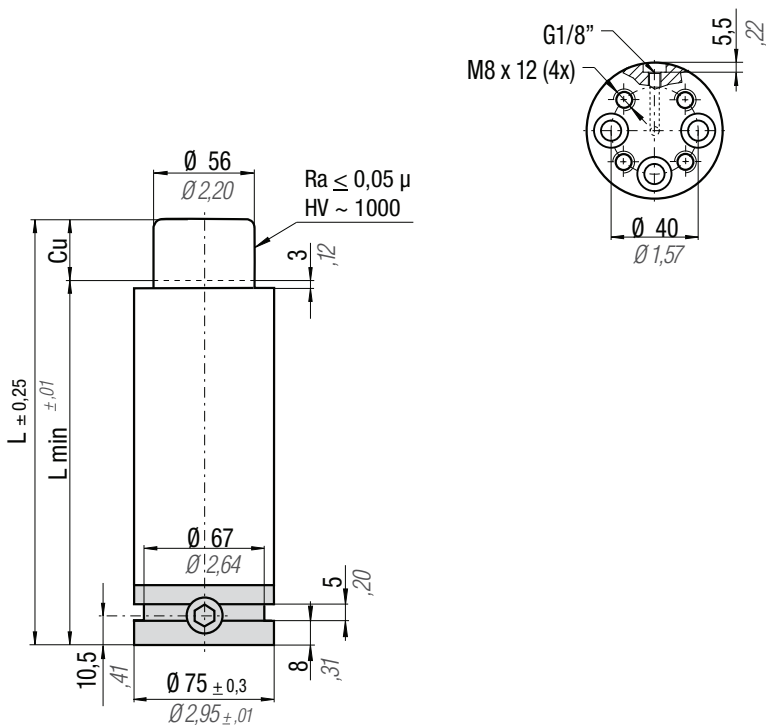

Info

* 100% Cu - Polytropic end forces

CODE	N ₂	°F 32 176	°C 0 80	ΔP ± 0,33 %/°C	P max 200 bar 2900 psi	P min 20 bar 290 psi	S 24,63 cm ² 3,817 in ²	SPM ~ 30 - 70 (at 20°C)	Max Speed 1,6 m/s	Maintenance kit 39BMKM47	Cu		L		L min		F ₀ Initial force		F ₁ End force *		V ₀		Weight		CE Cat.	
											mm	inch	mm	inch	mm	inch	daN	lb	daN	lb	cm ³	in ³	~Kg	~lb		
KM 47-15-C												15	0,59	120	4,72	105	4,13	4925	11071	8203	18441	129,0	7,87	2,56	5,64	-
KM 47-25-C												25	0,98	140	5,51	115	4,53	200 bar 2900 psi		9524	21411	177,0	10,80	2,76	6,08	-
KM 47-38-C												38	1,50	170	6,69	132	5,20			10275	23099	251,0	15,32	3,04	6,70	-
KM 47-50-C												50	1,97	200	7,87	150	5,91	± 5% +20 °C +68 °F		10499	23603	327,0	19,95	3,33	7,34	-
KM 47-63-C												63	2,48	230	9,06	167	6,57			10850	24392	402,0	24,53	3,60	7,94	-
KM 47-80-C												80	3,15	270	10,63	190	7,48	11118	24994	502,0	30,63	3,92	8,64	-		

Drop-in

Through plate

Bottom mount
05574 - 05919
05919/M

04757 - 06154
06190 - 06163

04759/C - 06759/C

HOW TO ORDER

(10 pcs) KM47-50-C

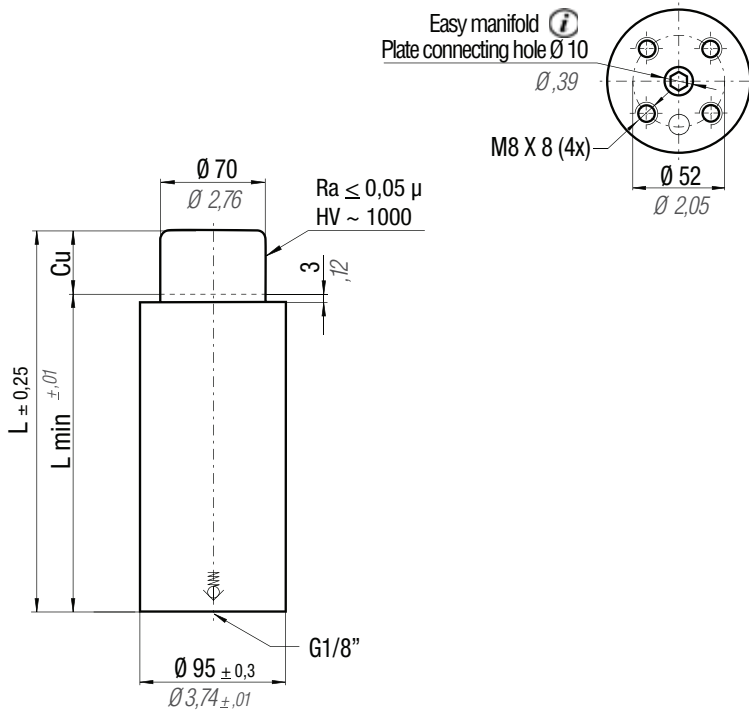

Info

* 100% Cu - Polytropic end forces

page 164

! For Easy manifold replacement units quote product code marked on your cylinders.

CODE	N ₂	°F 32 - 176	°C 0 - 80	ΔP ± 0,33 %/°C	P max 200 bar 2900 psi	P min 20 bar 290 psi	S 38,48 cm ² 5,964 in ²	SPM ~ 20 - 60 (at 20°C)	Max Speed 1,6 m/s	Maintenance kit 39BMKM75	
										~Kg	~lb
											CE
KM 75 - 15											
KM 75 - 25											
KM 75 - 38											
KM 75 - 50											
KM 75 - 63											
KM 75 - 80											

FKM 75

code: 39FML07500A

Kit speciale per trasformare cilindri autonomi
Special kit to convert self-contained cylinders
Spezial-Set zum Umbau eigenständiger Zylinder
Kit spécial pour transformer les cylindres autonomes
Kit especial para transformar cilindros autónomos
Kit especial para transformar cilindros autónomos

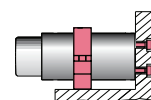
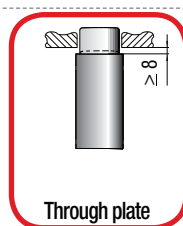
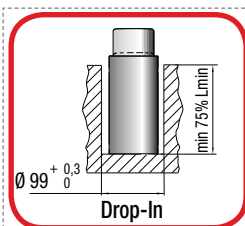
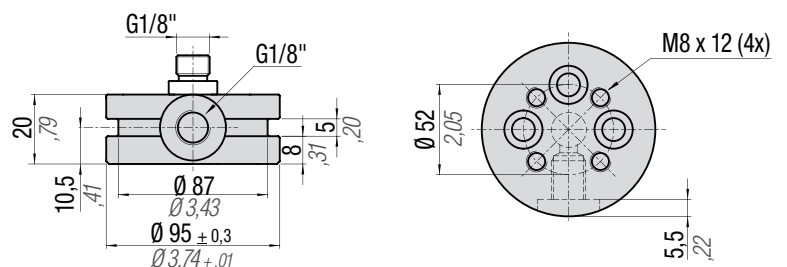

Bottom mount 04762/C - 06770/C

HOW TO ORDER

(10 pcs) KM75-50
(10 pcs) KM75-50-EN

KM 75 C

linkable G1/8"

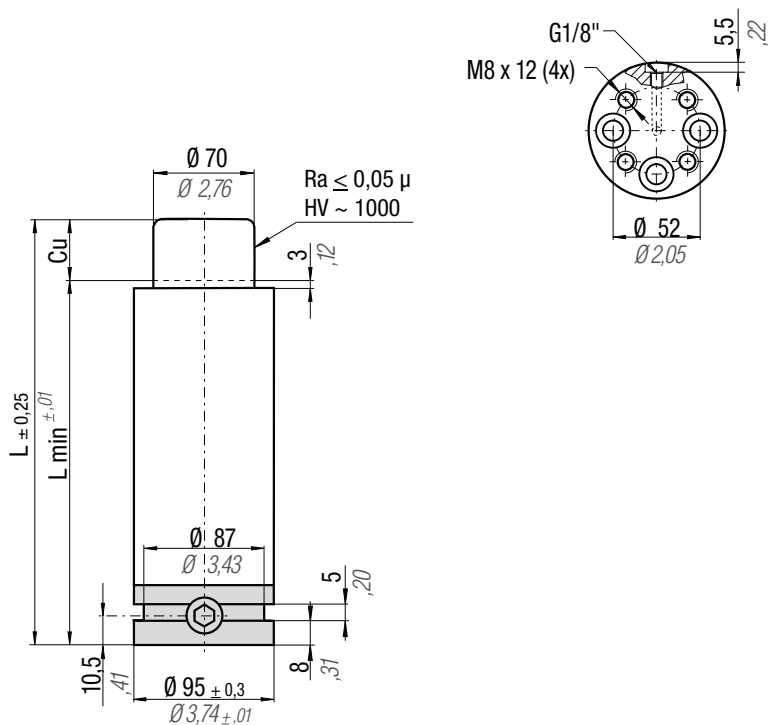

Info

* 100% Cu - Polytropic end forces

CODE	N ₂	°F 32 - 176	°C 0 - 80	ΔP $\pm 0,33 \% / ^\circ C$	P max 200 bar 2900 psi	P min 20 bar 290 psi	S 38,48 cm ² 5,964 in ²	SPM ~ 20 - 60 (at 20°C)	Max Speed 1,6 m/s	Maintenance kit 39BMKM75	Cu		L		L min		F ₀ Initial force		F ₁ End force *		V ₀		Cat.		
											mm	inch	mm	inch	mm	inch	daN	lb	daN	lb	cm ³	in ³	~Kg	~lb	
KM 75-15-C											15	0,59	135	5,31	120	4,72	7700	17310	12040	27067	239,0	14,58	4,63	10,21	-
KM 75-25-C											25	0,98	155	6,10	130	5,12	200 bar 2900 psi $\pm 5\%$ +20 °C +68 °F		13872	31185	313,0	19,10	4,94	10,89	-
KM 75-38-C											38	1,50	185	7,28	147	5,79			15048	33829	429,0	26,18	5,50	12,13	-
KM 75-50-C											50	1,97	210	8,27	160	6,30			16107	36210	523,0	31,92	5,77	12,72	-
KM 75-63-C											63	2,48	240	9,45	177	6,97			16620	37363	640,0	39,05	6,25	13,78	-
KM 75-80-C											80	3,15	280	11,02	200	7,87			17009	38238	796,0	48,57	6,86	15,12	-

Drop-in

Through plate

Bottom mount

04760 - 06155
06047 - 06164
04762/C - 06770/C

HOW TO ORDER

(10 pcs) KM75-50-C

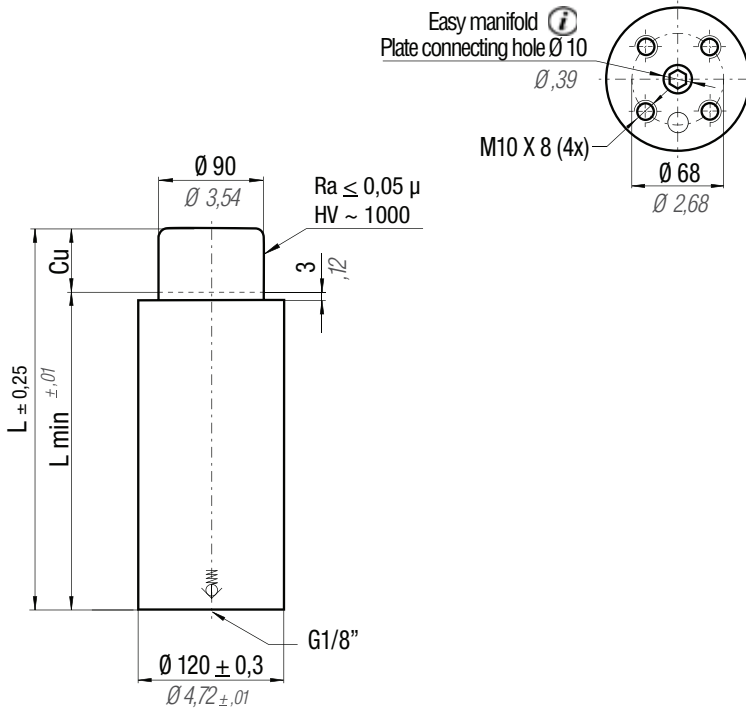

Info

* 100% Cu - Polytropic end forces

page 164

! For Easy manifold replacement units quote product code marked on your cylinders.

	N ₂	°F 32 - 176	°C 0 - 80	ΔP ± 0,33 %/°C	P max 200 bar 2900 psi	P min 20 bar 290 psi	S 63,62 cm ² 9,861 in ²	SPM ~ 20 - 50 (at 20°C)	Max Speed 1,6 m/s	Maintenance kit 39BMKM120						
CODE				Cu	L	L min	F0 Initial force	F1 End force *	V0		CE					
		mm	inch	mm	inch	mm	inch	daN	lb	cm ³	in ³	~Kg	~lb	Cat.		
KM 120 - 15		15	0,59	115	4,53	100	3,94	12720	28595	20981	47167	-	-	5,84	12,87	-
KM 120 - 25		25	0,98	135	5,31	110	4,33			24450	54966	-	-	6,55	14,44	-
KM 120 - 38		38	1,50	165	6,50	127	5,00			26556	59700	-	-	7,25	15,98	-
KM 120 - 50		50	1,97	195	7,68	145	5,71			27262	61287	-	-	8,06	17,77	-
KM 120 - 63		63	2,48	225	8,86	162	6,38			28269	63551	-	-	9,14	20,15	II
KM 120 - 80		80	3,15	265	10,43	185	7,28	± 5%	+20 °C +68 °F	29061	65332	-	-	9,84	21,69	II

FKM 120

code: 39FML12000A

Kit speciale per trasformare cilindri autonomi
Special kit to convert self-contained cylinders
Spezial-Set zum Umbau eigenständiger Zylinder
Kit spécial pour transformer les cylindres autonomes
Kit especial para transformar cilindros autónomos
Kit especial para transformar cilindros autónomos

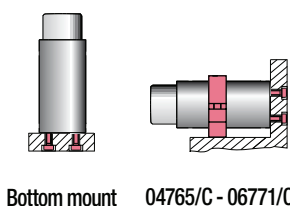
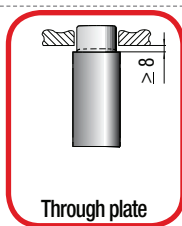
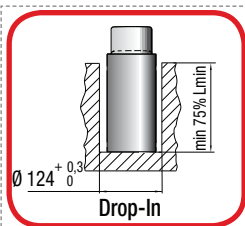
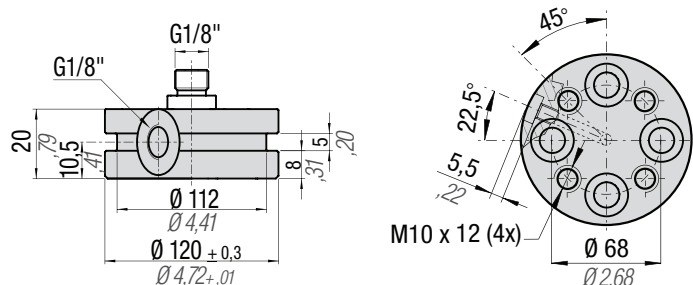

HOW TO ORDER

(10 pcs) KM120-50
(10 pcs) KM120-50-EN

KM 120 C

linkable G1/8"

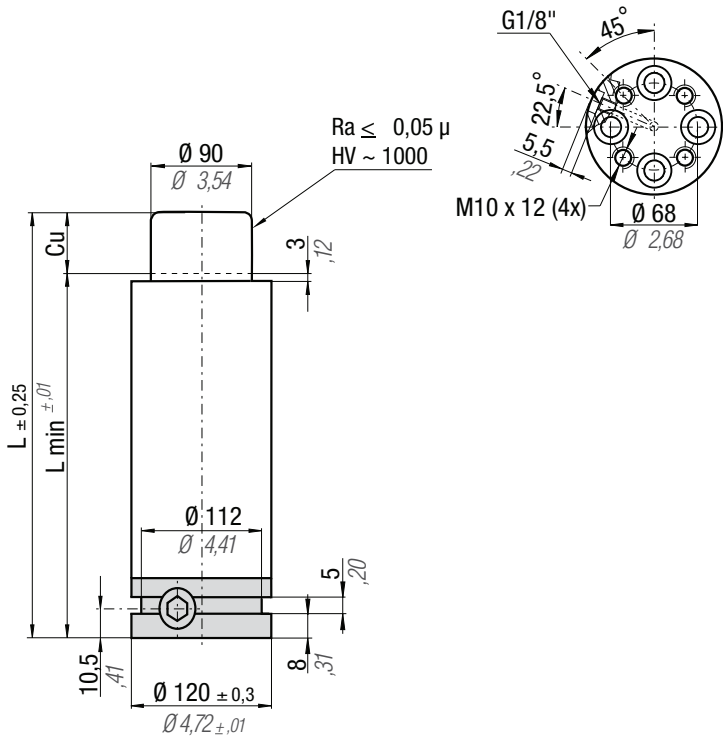

Info

* 100% Cu - Polytropic end forces

CODE	N ₂	°F 32 - 176	°C 0 - 80	ΔP $\pm 0,33 \text{ %/}^\circ\text{C}$	P max 200 bar 2900 psi	P min 20 bar 290 psi	S 63,62 cm ² 9,861 in ²	SPM ~ 20 - 50 (at 20°C)	Max Speed 1,6 m/s	Maintenance kit 39BMKM120	Cu		L		L min		F ₀ Initial force		F ₁ End force *		V ₀		Cat.			
											mm	inch	mm	inch	mm	inch	daN	lb	daN	lb	cm ³	in ³	~Kg	~lb		
KM 120-15-C												15	0,59	135	5,31	120	4,72	12720	28595	20981	47167	350,0	21,36	7,60	16,76	-
KM 120-25-C												25	0,98	155	6,10	130	5,12	20981	47167	24450	54966	467,0	28,50	8,31	18,32	-
KM 120-38-C												38	1,50	185	7,28	147	5,79	20981	47167	26556	59700	650,0	39,66	9,01	19,86	-
KM 120-50-C												50	1,97	215	8,46	165	6,50	20981	47167	27262	61287	838,0	51,14	9,82	21,65	-
KM 120-63-C												63	2,48	245	9,65	182	7,17	20981	47167	28269	63551	1021,0	62,30	10,90	24,03	II
KM 120-80-C												80	3,15	285	11,22	205	8,07	20981	47167	29061	65332	1267,0	77,32	11,60	25,57	II

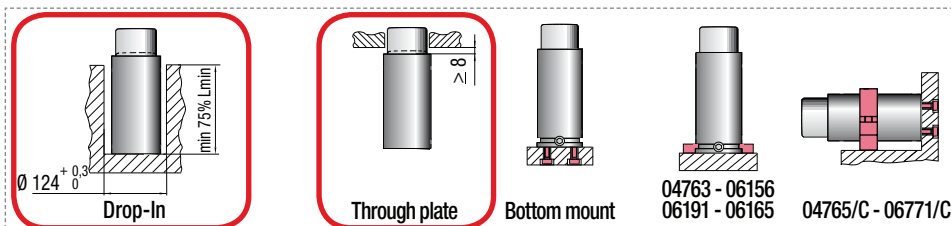

HOW TO ORDER

(10 pcs) KM120-50-C