

Renault		
Mercedes Benz		
Susuki		

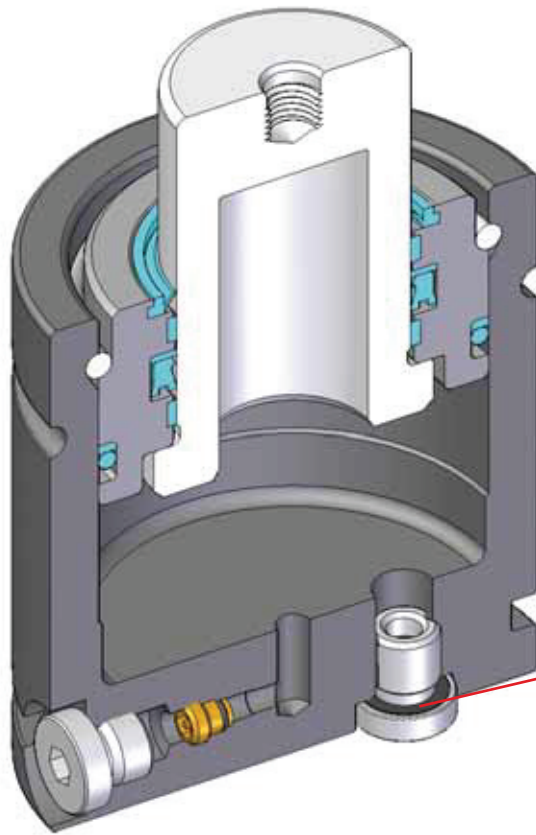

OLD Code AR/C-xxx-yy  
NEW Code AR/C-xxx-yy.1



**Over  
Pressure  
Active  
Safety**

## Range chart

Model	Body Ø		Stroke C <sub>U</sub>		Initial force		 OPAS OSAS SKUDO USAS			
	mm	inch	mm	inch	daN	lb				
AR/C 5	45	1,77	6 - 125	0,24 - 4,92	470	1057	-	-	-	-
AR/C 7,5	50	1,97	6 - 125	0,24 - 4,92	740	1664	-	-	-	-
AR/C 15	75	2,95	25 - 100	0,98 - 3,94	1530	3440	✓	-	-	-
AR/C 30	95	3,74	25 - 100	0,98 - 3,94	2945	6621	✓	-	-	-



**How  
to  
Order**

## AR/C 15-50.1 - C - E

Codice cilindro autonomo  
Self-contained cylinder code  
Kode des eingeständiges Zylinder  
Code du cylindre autonome  
Codigo del cilindro autónomo  
Codigo do cilindro autónomo

Collegabile con tubi, cilindro fornito scarico e senza valvola unidirezionale  
Linkable with hoses, cylinder supplied without pressure and oneway valve  
Anschlussfähig mit Leitungen, Zylinder geliefert ohne Druck und RückschlagVentil  
Connectable avec tubes, ressort fourni sans pression ni valve unidirectionelle  
Connectable con tubos, cilindro suministrado sin presión y sin válvula unidireccional  
Acompláveis com tubos, cilindro fornecidos sem pressão e sem válvula unidireccional

Collegabile EASY MANIFOLD, fornito scarico + guarnizione di collegamento  
Linkable EASY MANIFOLD, supplied without pressure + connecting seal  
Anschlussfähig EASY MANIFOLD, geliefert ohne Druck + Verbindungsdichtung  
Connectable EASY MANIFOLD, fourni sans pression + joint de connexion  
Connectable EASY MANIFOLD, suministrado sin presión + junta de conexión  
Acompláveis EASY MANIFOLD, fornecidos sem pressão + vedantes de conexão

	EM24.54.700 (Renault)
	SES-K 5404E (Suzuki)

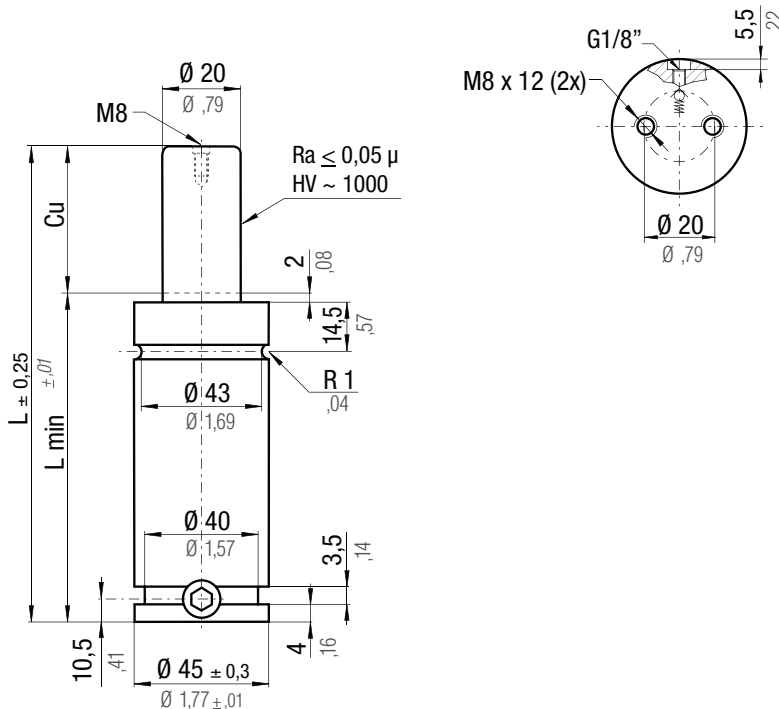

**Info**

\* 100% Cu - Polytropic end forces

Il nuovo codice sarà fornito solo ad esaurimento del vecchio

The new code will be supplied only when the old will be out of stock

Der neue Kode wird geliefert nur wenn der alte nicht mehr im Lager ist



Le nouveau code sera fourni uniquement lorsque le vieux stock sera écoulé

El nuevo código será suministrado sólo cuando el viejo está fuera de stock

O novo código irá ser fornecido apenas quando o antigo esgotar stock

AR/C

	<b>N<sub>2</sub></b>	<b>°F</b> 32 - 176	<b>°C</b> 0 - 80	<b>ΔP</b> ± 0,33 %/°C	<b>P max</b> 150 bar 2175 psi	<b>P min</b> 20 bar 290 psi	<b>S</b> 3,14 cm <sup>2</sup> 0,487 in <sup>2</sup>	<b>SPM</b> ~ 40 - 100 (at 20°C)	<b>Max Speed</b> 1,8 m/s	<b>Maintenance kit</b> 39BMAR/C5.1
--	----------------------	-----------------------------	---------------------------	--------------------------	-------------------------------------	-----------------------------------	---	---------------------------------------	-----------------------------	---------------------------------------

CODE	PHASING OUT	NEW	Cu		L		L min		F0		F1		V0		~Kg		Cat.
			mm	inch	mm	inch	mm	inch	daN	lb	daN	lb	cm <sup>3</sup>	in <sup>3</sup>	~lb		
AR/C 5 - 6		AR/C 5 - 6.1	6	0,24	62	2,44	56	2,20	470	1057	648	1457	7,1	0,43	0,51	1,12	-
AR/C 5 - 13		AR/C 5 - 13.1	13	0,51	76	2,99	63	2,48			714	1604	14,4	0,88	0,56	1,23	-
AR/C 5 - 19		AR/C 5 - 19.1	19	0,75	88	3,46	69	2,72			749	1683	20,6	1,26	0,60	1,32	-
AR/C 5 - 25		AR/C 5 - 25.1	25	0,98	100	3,94	75	2,95			772	1736	26,9	1,64	0,65	1,43	-
AR/C 5 - 38		AR/C 5 - 38.1	38	1,50	126	4,96	88	3,46	150 bar 2175 psi		802	1804	40,4	2,46	0,74	1,63	-
AR/C 5 - 50		AR/C 5 - 50.1	50	1,97	150	5,91	100	3,94			819	1840	52,9	3,23	0,83	1,83	-
AR/C 5 - 63		AR/C 5 - 63.1	63	2,48	176	6,93	113	4,45	± 5% + 20 °C + 68 °F		786	1767	66,4	4,05	0,96	2,12	-
AR/C 5 - 80		AR/C 5 - 80.1	80	3,15	210	8,27	130	5,12			799	1797	84,1	5,13	0,99	2,18	-
AR/C 5 - 100		AR/C 5 - 100.1	100	3,94	250	9,84	150	5,91			813	1828	104,9	6,40	1,14	2,51	-
AR/C 5 - 125		AR/C 5 - 125.1	125	4,92	300	11,81	175	6,89			825	1855	130,7	7,97	1,32	2,91	-

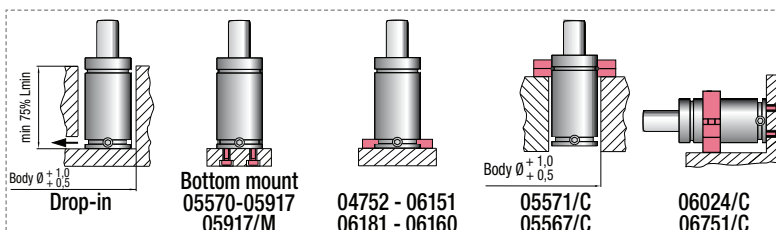

**HOW TO ORDER**

(10 pcs) AR/C 5-50.1  
(10 pcs) AR/C 5-50.1-C

# AR/C 7,5

**PED**  
97/23/EC

B8 3180 220 000 003(MB)  
EM24.54.700 (Renault)  
SES-K 5404E (Suzuki)

**VEP** AUTOMATION  
made by Special Springs

## Info

\* 100% Cu - Polytropic end forces

Il nuovo codice sarà fornito solo ad esaurimento del vecchio

The new code will be supplied only when the old will be out of stock

Der neue Kode wird geliefert nur wenn der alte nicht mehr im Lager ist



Le nouveau code sera fourni uniquement lorsque le vieux stock sera écolé

El nuevo código será suministrado sólo cuando el viejo está fuera de stock

O novo código irá ser fornecido apenas quando o antigo esgotar stock

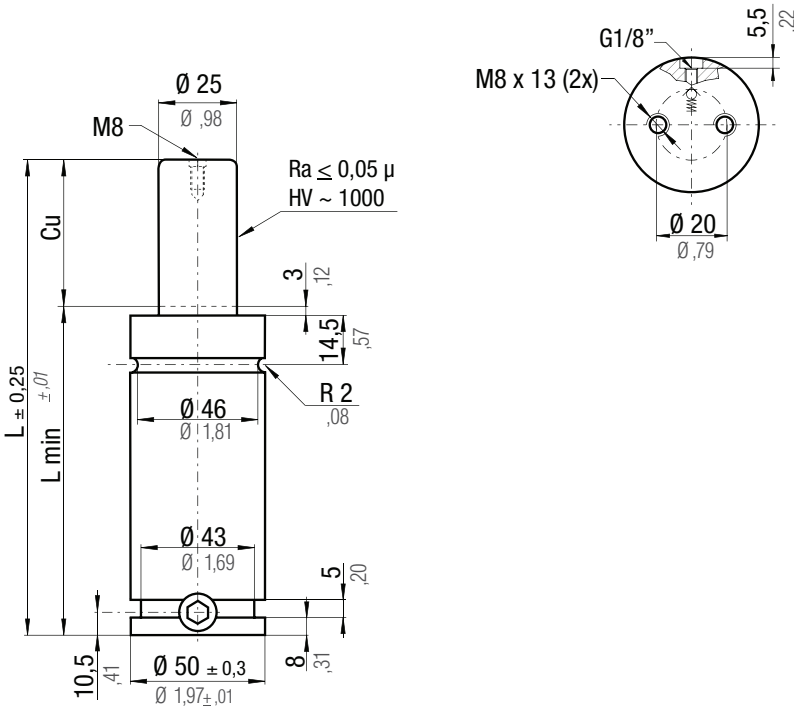

N <sub>2</sub>		°F 32 176	°C 0 80	ΔP ± 0,33 %/°C	P max 150 bar 2175 psi	P min 20 bar 290 psi	S 4,91 cm <sup>2</sup> 0,761 in <sup>2</sup>	SPM ~ 30 - 80 (at 20°C)	Max Speed 1,8 m/s	Maintenance kit 39BMAR/C7,5.1								
CODE	NEW	Cu		L		L min		F0 Initial force		F1 End force *		V0		CE Cat.				
PHASING OUT	NEW	mm	inch	mm	inch	mm	inch	daN	lb	daN	lb	cm <sup>3</sup>	in <sup>3</sup>	~Kg	~lb			
AR/C 7,5 - 6	AR/C 7,5 - 6 . 1	6	0,24	62	2,44	56	2,20	740	1664	1078	2424	39,5	2,41	0,59	1,30	-		
AR/C 7,5 - 13	AR/C 7,5 - 13 . 1	13	0,51	76	2,99	63	2,48			1245	2798	49,7	3,03	0,65	1,43	-	-	-
AR/C 7,5 - 19	AR/C 7,5 - 19 . 1	19	0,75	88	3,46	69	2,72			1330	2991	58,5	3,57	0,70	1,54	-	-	-
AR/C 7,5 - 25	AR/C 7,5 - 25 . 1	25	0,98	100	3,94	75	2,95			1388	3121	67,2	4,10	0,76	1,68	-	-	-
AR/C 7,5 - 38	AR/C 7,5 - 38 . 1	38	1,50	126	4,96	88	3,46	150 bar 2175 psi		1466	3295	86,2	5,26	0,80	1,76	-		
AR/C 7,5 - 50	AR/C 7,5 - 50 . 1	50	1,97	150	5,91	100	3,94			1509	3391	103,7	6,33	1,00	2,20	-	-	-
AR/C 7,5 - 63	AR/C 7,5 - 63 . 1	63	2,48	176	6,93	113	4,45	± 5% + 20 °C + 68 °F		1539	3461	122,6	7,48	1,10	2,43	-		
AR/C 7,5 - 80	AR/C 7,5 - 80 . 1	80	3,15	210	8,27	130	5,12			1566	3521	147,4	8,99	1,70	3,75	-	-	-
AR/C 7,5 - 100	AR/C 7,5 - 100 . 1	100	3,94	250	9,84	150	5,91			1588	3569	176,6	10,77	1,96	4,32	-	-	-
AR/C 7,5 - 125	AR/C 7,5 - 125 . 1	125	4,92	300	11,81	175	6,89			1606	3610	213,0	12,99	2,07	4,56	-		

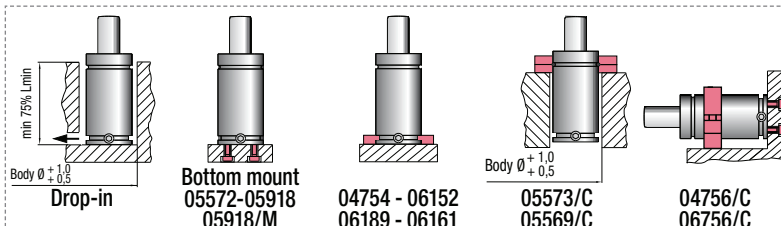

## HOW TO ORDER

(10 pcs) AR/C 7,5-50.1  
(10 pcs) AR/C 7,5-50.1-C



# AR/C 30

EM24.54.700 (Renault)

**VEP** AUTOMATION  
made by Special Springs

lifeplus **PED**  
concept 97/23/EC

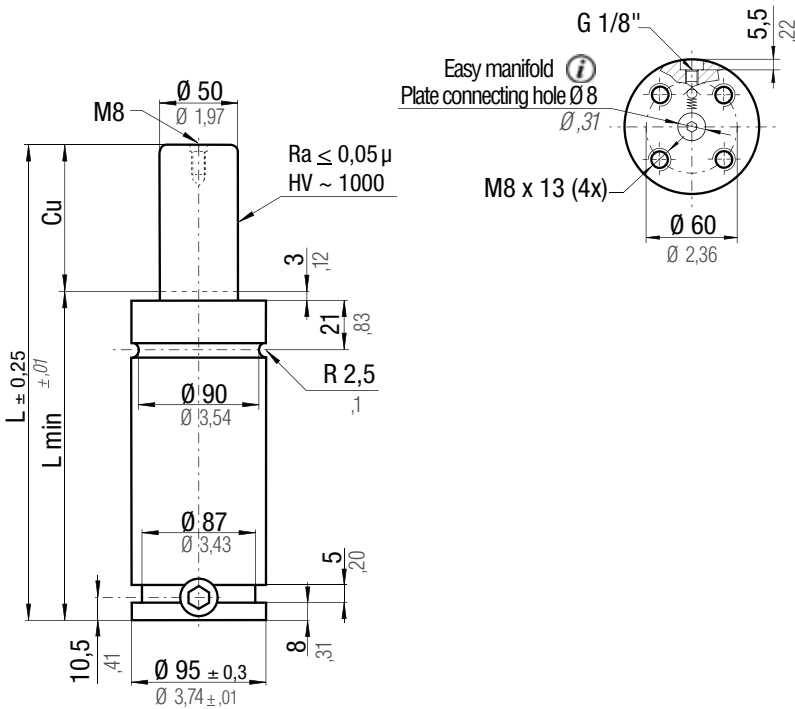

## Info

\* 100% Cu - Polytropic end forces

page 164

Il nuovo codice sarà fornito solo ad esaurimento del vecchio

The new code will be supplied only when the old will be out of stock

Der neue Kode wird geliefert nur wenn der alte nicht mehr im Lager ist

Le nouveau code sera fourni uniquement lorsque le vieux stock sera écoulé

El nuevo código será suministrado sólo cuando el viejo está fuera de stock

O novo código irá ser fornecido apenas quando o antigo esgotar stock

For Easy manifold replacement units quote product code marked on your cylinders.

N <sub>2</sub>		°F 32 - 176	°C 0 - 80	$\Delta P$ $\pm 0,33 \% / ^\circ C$	P max 150 bar 2175 psi	P min 20 bar 290 psi	S 19,63 cm <sup>2</sup> 3,043 in <sup>2</sup>	SPM ~ 15 - 60 (at 20°C)	Max Speed 1,8 m/s	Maintenance kit 39BMAR/C30.1						
CODE		Cu		L	L min	F0 Initial force		F1 End force *		V0		CE				
PHASING OUT	NEW	mm	inch	mm	inch	mm	inch	daN	lb	cm <sup>3</sup>	in <sup>3</sup>	~Kg	~lb	Cat.		
AR/C 30 - 25	AR/C 30 - 25.1	25	0,98	120	4,72	95	3,74	2945	6621	5995	13477	169,9	10,36	4,07	8,97	-
AR/C 30 - 38	AR/C 30 - 38.1	38	1,50	146	5,75	108	4,25	150 bar 2175 psi		6391	14368	243,3	14,84	4,53	9,99	-
AR/C 30 - 50	AR/C 30 - 50.1	50	1,97	170	6,69	120	4,72			6612	14865	311,0	18,97	5,16	11,38	-
AR/C 30 - 63	AR/C 30 - 63.1	63	2,48	196	7,72	133	5,24	$\pm 5\%$ $+ 20 ^\circ C + 68 ^\circ F$		6773	15227	384,3	23,44	5,44	11,99	-
AR/C 30 - 80	AR/C 30 - 80.1	80	3,15	230	9,06	150	5,91			6916	15547	480,3	29,30	6,05	13,34	-
AR/C 30 - 100	AR/C 30 - 100.1	100	3,94	270	10,63	170	6,69	7028	15800	593,1	36,18	6,78	14,95	-		

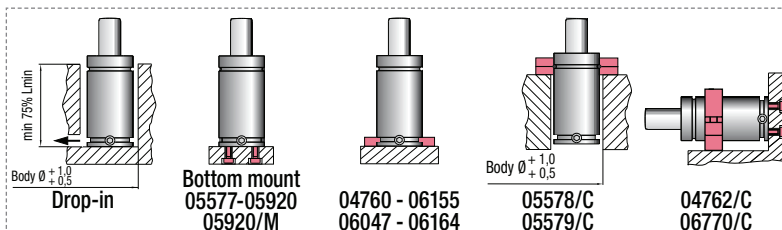

## HOW TO ORDER

(10 pcs) AR/C 30-50.1  
(10 pcs) AR/C 30-50.1-C  
(10 pcs) AR/C 30-50.1-E