

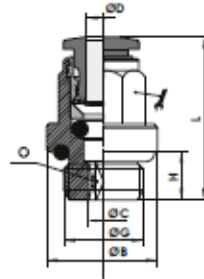

## gerade Steckverbindung / Push-in Fitting 01



**Material:** Messing  
**Material:** brass

CODE	ØB	ØC	ØD	G	H	L		Bemerkungen / Note
0104M5	9	2,6	4	M5	4	20,5	Ø9	
010418	13,5	2,6	4	1/8	5,5	20	9	
0106M5	11	2,6	6	M5	4	22,8	Ø11	
010618	13,5	4,2	6	1/8	5,5	25,3	11	
010614	17	4,2	6	1/4	6,5	24,3	11	
010818	12,8	5,2	8	1/8	5,5	27	13	
010814	17	6,2	8	1/4	6,5	25,5	13	

## L-Steckverbindung / Push-in Fittings 22

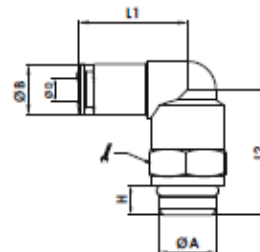

**Material:** Messing  
**Material:** brass

CODE	A	ØB	ØD	H	L1	L2		Bemerkungen / Note
2204M5	M5	9,1	4	4	17,3	14,8	9	
220418	1/8	9,1	4	6	18	20	13	
2206M5	M5	11	6	4	14,5	21	9	
220618	1/8	11	6	6	23	20	13	
220614	1/4	11	6	8	23	24	13	
220818	1/8	13	8	6	25,5	20,3	13	
220814	1/4	13	8	8	25,5	24,3	13	



## Drosselrückschlagventil / Flow Regulator T29



Material: Messing  
Material: brass

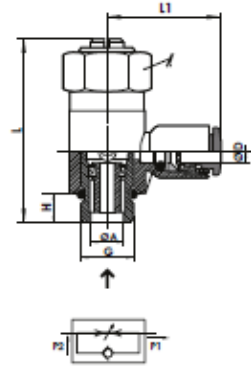

CODE	øA	øD	G	H	L	L1		Bemerkungen / Note
T290618	5	6	1/8	5,5	34	24,3	14	unidirektional / unidirectional
T290614	6	6	1/4	6,5	42	25,5	17	
T290818	5	8	1/8	5,5	34	24,8	14	
T290814	6	8	1/4	6,5	42	26,5	17	

## Drosselrückschlagventil / Flow Regulator T29P



Material: Messing  
Material: brass

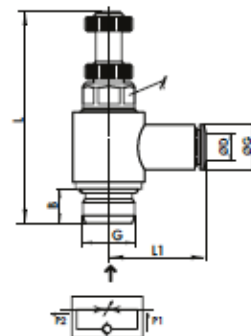

CODE	B	øD	G	L	L1		Bemerkungen / Note
T290618P	5,5	6	1/8	43	24,3	9	unidirektional / unidirectional
T290614P	6,5	6	1/4	50	25,5	12	
T290818P	5,5	8	1/8	43	24,8	9	
T290814P	6,5	8	1/4	50	26,5	12	



## Reduzierstück / Reducer

### T08



**Material:** Kunststoff

**Material:** technopolymer

CODE	ØB	ØC	ØD1	ØD	L	L1	Bemerkungen / Note
T080604	9,5	3	6	4	35,5	19,5	
T080804	9,5	3	8	4	37	21	
T080806	11,5	5	8	6	39	23	

## T-Steckverbindung / T Connector

### T05

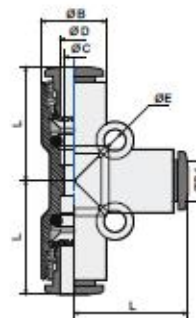

**Material:** Kunststoff

**Material:** technopolymer

CODE	ØB	ØC	ØD	ØD1	ØE	L	Bemerkungen / Note
T050604	13	5,3	6	4	2,4	19,2	
T050600	11,5	5	6	6	2,6	20,8	
T050806	14,4	7,1	8	6	3,2	22,7	
T050800	13,5	7	8	8	2,75	23	



## Steckverteiler / Push-in Fitting

**T18**

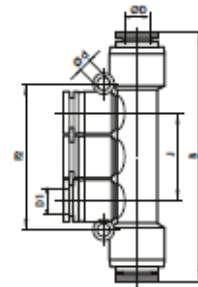

**Material:** Kunststoff

**Material:** technopolymer

COD.	B	ØD	ØD1	Ød	J	F2	Bemerkungen / Note
T180604	58	6	4	3,2	22	36	
T180804	63,4	8	4	3,2	26	42	
T180806	63,4	8	6	3,2	26	42	

## Y -Steckverbindung / Y Connector

**T23**

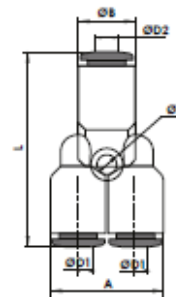
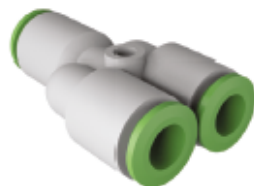

**Material:** Kunststoff

**Material:** technopolymer

CODE	A	ØB	ØD1	ØD2	ØE	L	Bemerkungen / Note
T230406	19	11,5	4	6	2,4	35,8	
T230600	23	11,5	6	6	2,6	38,6	
T230608	23	13,5	6	8	3,2	39,8	
T230800	27	16,5	8	8	2,75	42,5	



## Stopfen / Plug T09

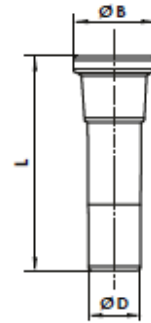

Material: Kunststoff

Material: technopolymer

COD.E	ØB	ØC	ØD	ØD1	L	L1	Bemerkungen / Note
T090400	7	--	4	--	25	--	
T090600	9,5	--	6	--	27,5	--	
T090800	12	--	8	--	30	--	

## Schlauch / Tube TPU

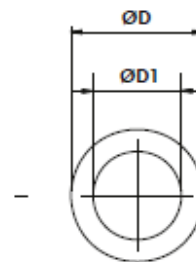

Material: Polyurethan

Material: polyurethane

P = Arbeitsdruck / working pressure  
P1 = Berstdruck / breaking pressure  
R = Biegeradius / bending radius

CODE	ØD	ØD1	P (bar)	P1 (bar)	R (mm)	Note
TPU0604BU	6	4	10	40	18	BU: blauer Schlauch / blue tube
TPU0604GR	6	4	10	40	18	GR: grüner Schlauch / green tube
TPU0806BU	8	6	7	28	35	BU: blauer Schlauch / blue tube
TPU0806GR	8	6	7	28	35	GR: grüner Schlauch / green tube



Doppelschlauch / Bitube  
**A4TUP**

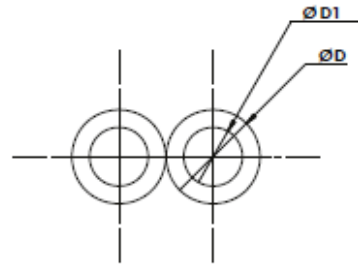

**Material:** Polyurethan

**Material:** polyurethane

CODE	ØD	ØD1	P (bar)	P1 (bar)	R (mm)	Bemerkungen / Note
BTPU042.5GRBU	4	2,5	--	--	--	hitzeversiegelt / heat-sealed